

# *Excavations on a First-Century Enclosure at Stanborough School, Welwyn Garden City*

J. R. HUNN

with contributions by  
James Rackham and Isobel Thompson

*Prior to the expansion of Stanborough School, Welwyn Garden City, a programme of archaeological fieldwork was undertaken to evaluate and record any remains that might be affected by the development. The evaluation located the 1st-century enclosure discovered on the site in the 1930s and retrieved a substantial contemporary ceramic assemblage, comprising grogged domestic wares, mostly local forms. The disposal of the assemblage in the enclosure ditch appeared to represent a single event. The work confirmed the presence, extent and date of the enclosure. The results of this evaluation and the earlier work at Stanborough are discussed in relation to other contemporary enclosed farmsteads in Hertfordshire.*

## **INTRODUCTION**

This project was developed as a result of a proposed expansion of Stanborough School, Welwyn Garden City. The first phase of evaluation was occasioned by the proposed construction of an extension to the school buildings, and was carried out in February 1997. However, following the merger of two local schools a further expansion of the school buildings and facilities was required. In anticipation of this, further evaluation was carried out on the site in December 1998. In the spring of 1999 a third phase of work involved a watching brief on the site during the construction of a new sports hall, science building, and an all-weather pitch. This revealed little of archaeological significance. The investigations were commissioned and funded by Hertfordshire County Council, and undertaken by Archaeological Services & Consultancy.

It is now almost half a century since the 1st-century enclosure at Stanborough was discovered and investigated (Arnold 1952-54). Since that date many of the analytical techniques of archaeology have changed, so it is fortunate that this opportunity arose to re-examine the site. Of equal if not greater importance was the existence of an element of uncertainty concerning the site's vulnerability to damage by further development. This has now been clarified. The work reported in this article has allowed the site to be re-plotted in relation to the school buildings, to establish the depth of the overburden and hence the degree to which it is protected, and to permit a reappraisal of the ceramic assemblage and its associated environmental data.

## **Topography**

The site is located on the edge of a flat to gently undulating plateau overlooking the Lea valley, centred on NGR TL 2285 1162, at an elevation of 80-85m OD (Fig. 1). The river Lea flows less than 250m to the west of the site, and some 25m lower in elevation. The site is in a classic location for one of its type, with access to a range of different land-forms and uses. The local soils are derived from glaciofluvial drift, and belong to the Ludford Association (Hodge *et al* 1984, 237). These are characterised by deep, well-drained fine loamy, coarse loamy and sandy soils, locally flinty

and in places over gravel (Soil Survey 1983, 12). The soils around the enclosure are classified (MAFF 1979, 14) as Grade 3 agricultural land with moderate limitations due to soil, relief and climate. These soils would have favoured grass and cereals (*ibid*, 15).

## **Historical & Archaeological Background**

There is no readily available evidence relating to the history of the site. Until the 1930s, the site and surrounding area was farmed either by Lower Handside Farm, to the north, or Stanborough Farm, to the south. The site lay in the ancient parish of Hatfield, and probably belonged originally to the lands of the manor of Hatfield. By the 14th century, if not earlier, the site may have formed part of the lands of the sub-manor of Handside (Page 1912, 103). By the end of the 16th century Handside Manor was absorbed into the Brocket estates (*ibid*).

The site was discovered in 1938 during the construction of what was then Welwyn Grammar School. Observations were recorded by Mr W.R. Hughes (Hughes 1938). Some fifteen years later further discoveries were made as the school expanded. This work revealed that the site comprised an enclosed settlement some 46 × 61m (0.28ha), dated to the mid 1st century AD. The archaeology was described by Mr B.J. Arnold and the pottery by Mr J. Holmes (Arnold 1952-54). The results of the 1950s work are discussed below.

## **Methodology**

The 1997 evaluation trench (Trench 1) was aligned with the principal NE-SW axis of the new building (Fig. 1). The trench measured 27.0 × 1.9m, widening to approximately 3.75m at its north-eastern end. Excavations revealed a 6.0m-length of ditch, which was then excavated by hand. All individual contexts were recorded, sections were photographed and drawn, and a sample was taken from the secondary fill for environmental analysis. The site was planned in relationship to the present science building. The results have since been compared with the 1950s discoveries, and a new plan has been prepared illustrating the relationship of the enclosure to the present layout of the school buildings.

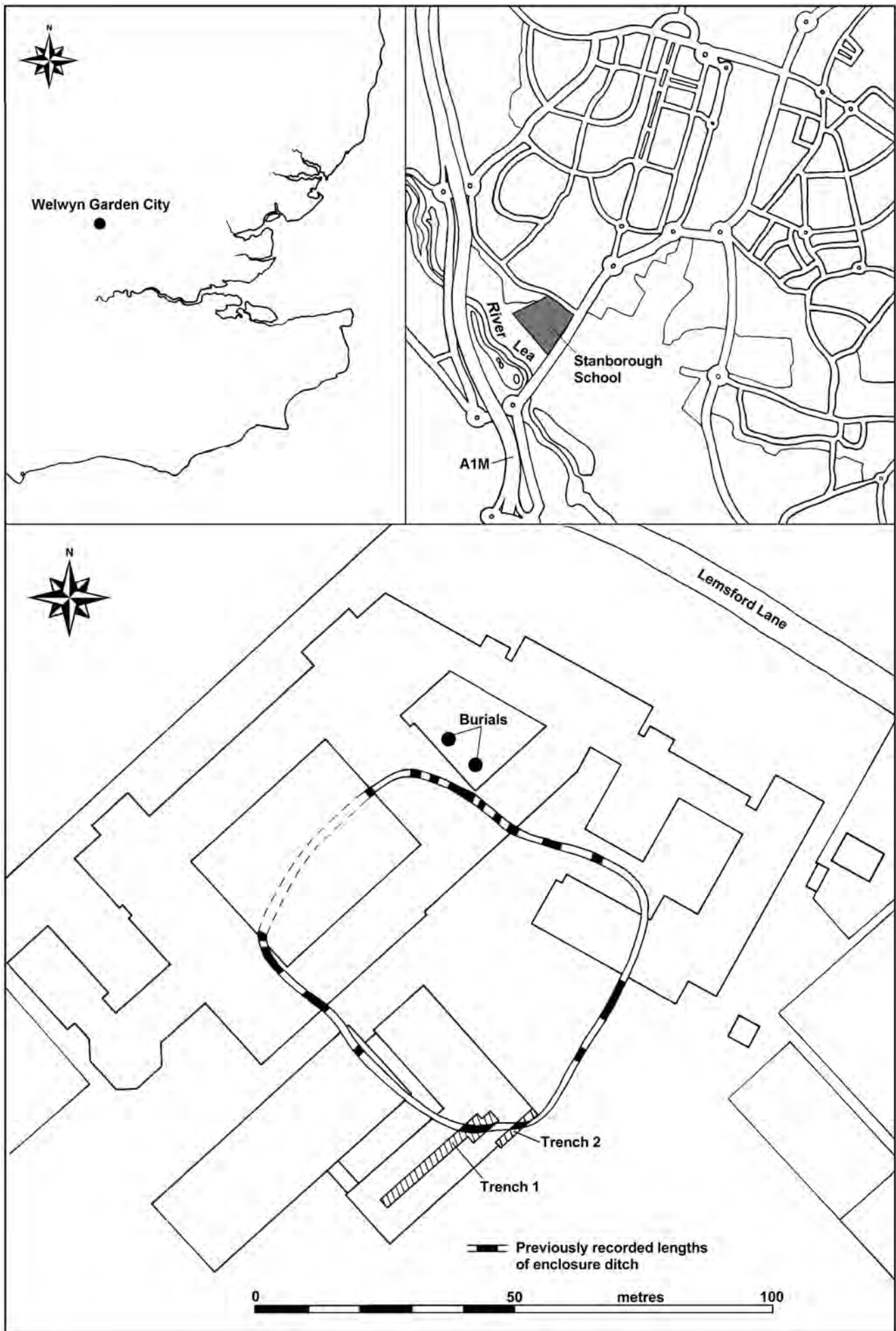

Fig 1 Site and trench location plan

The 1998 evaluation consisted of two trenches and five test-pits. Trench 2 measured 15.0 × 1.8m. Trench 3 (26.0 × 1.8m) was located c.45m to the south-east, and revealed no archaeological deposits. Test pits 1-5, each measuring 1.8m square, were upwards of 70m to the north-east, and proved similarly barren. Only Trench 2, in which the enclosure ditch was located, is illustrated and described below.

## THE EXCAVATIONS

### Trench 1 (Fig. 2: Plates 1 & 2)

Below topsoil (001) were four distinct layers of clay and clay loam (002, 006, 007 and 008). All were removed by machine, so no datable finds were recovered. The first archaeological horizon was encountered some 0.75m below ground level. It consisted of a flat-bottomed ditch with sloping sides, located at the east end of the trench, towards the south corner of the settlement enclosure. It was orientated more or less east to west, and was about 1.50m wide and 0.85m deep. Two segments (042 and 021) were excavated.

The westernmost segment (042) contained evidence for three possible recuts. Only a small portion of 017, the primary fill of the original ditch [038], survived on its western edge. This consisted of brown plastic silty clay, with occasional small rounded pebbles but no finds. The first recut [011] contained a single fill, 016, comprising dark yellowish brown, plastic sandy clay with occasional small rounded pebbles, almost certainly derived from natural weathering of the ditch sides. The second recut [036] also contained 015, a brown plastic silty clay containing sub-angular flints, but no finds. The third recut [037] contained three fills. The primary fill, 014, was very dark

greyish brown, plastic silty clay, containing a considerable quantity (4.9kg) of pottery, and also burnt stones, bone and charcoal. The secondary fill, 013, was dark yellowish brown, plastic silty clay also containing pottery (0.67kg) and a fragment of Hertfordshire Puddingstone beehive quern. The uppermost fill, 012, consisted of dark brown, plastic silty clay, containing occasional small pebbles and medium to large sub-angular flints.

The second segment (042) contained evidence for one recut. The primary cut [021] contained fills 030 and 031, consisting of dark yellowish brown plastic clay containing small pebbles, but no finds. The recut [039] contained four fills. Its primary fill, 028, consisted of dark greyish-brown, plastic silty clay containing a high proportion of flints, fired clay and pottery. The second fill, 025, comprised brown plastic silty clay containing frequent stones and 3.28kg of pottery. The third fill, 023, consisted of brown, plastic, silty clay with moderate to large sized flints, but no finds. The uppermost fill, 022, was brown sandy friable clay silt, containing medium rounded stones and a considerable quantity (4.09kg) of pottery.

The only other feature in Trench 1 was a shallow pit or post-hole [009] 0.60m wide and 0.15m deep, sealed beneath [008], about 1.9m south of the enclosure ditch (not on plan). It contained a single fill [010] comprising brown plastic sandy clay with occasional gravel pebbles, but no finds. Its function is not known.

### Trench 2 (Fig. 3)

This was placed 3.0m to the east of and parallel to Trench 1, to pick up the ditch described above. As before, below topsoil (100) the overburden comprised four layers of clay and gravel

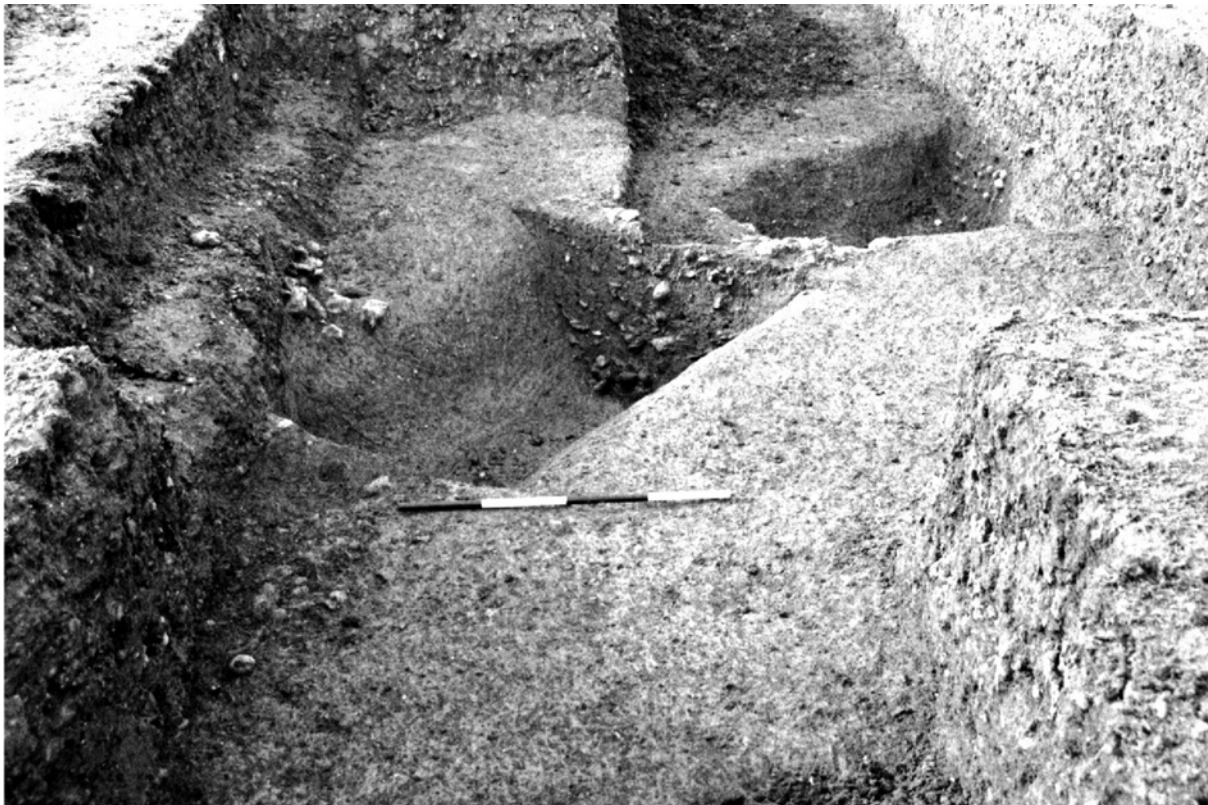

Plate 1 Trench 1, the enclosure ditch after excavation, from north-east.

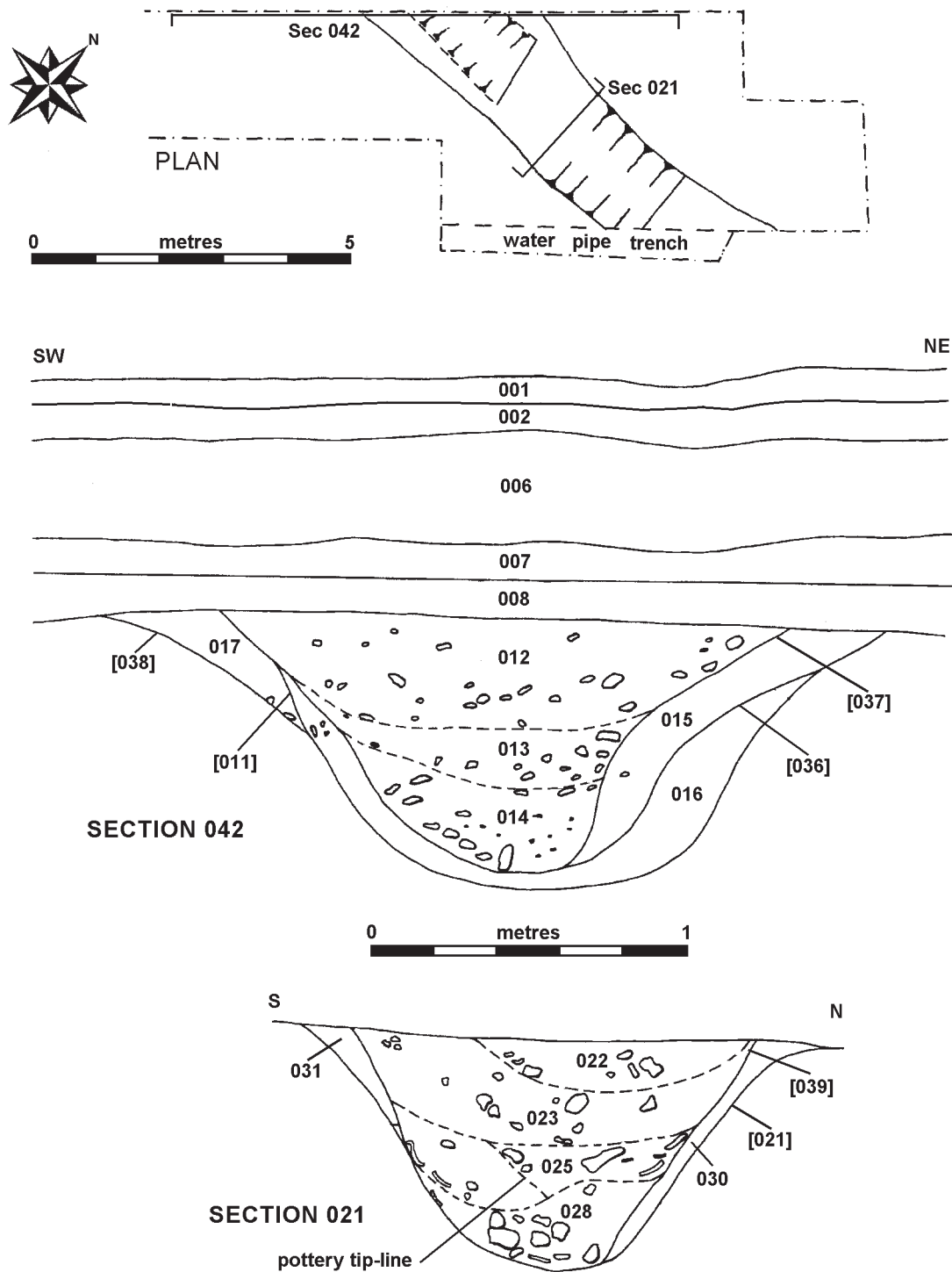

Fig 2 Trench 1, plan and sections

soils (101, 102, 103, and 104) totalling 0.75m in depth. It was removed by machine, so no datable material was recovered. Within Trench 2 were three distinct features:

**Hollow [106]** was a broad shallow hollow with a probable diameter of c.10m. It had a maximum depth of 0.35m and contained two fills, 104 and 105. The primary fill (105) consisted of dark silty clay with frequent pebbles, containing five sherds of pottery. Above this was a secondary fill, 104, which has been mentioned above. The fill of the hollow appeared to have been cut by Enclosure Ditch 109.

**Posthole [111]** was c.0.24m in diameter and 0.04m deep, cut into the natural clay. It was filled with 110, greyish brown silty clay. There were no finds and its function and relationship to the other features in Trench 2 was never established.

**Ditch [109]** followed the same east-west alignment as the ditch revealed in Trench 1, and was most likely a continuation of it. A single segment was excavated, 1.42m in length. The ditch was 0.80m wide and 0.66m deep, and contained a single fill (108). This was dark yellowish-brown

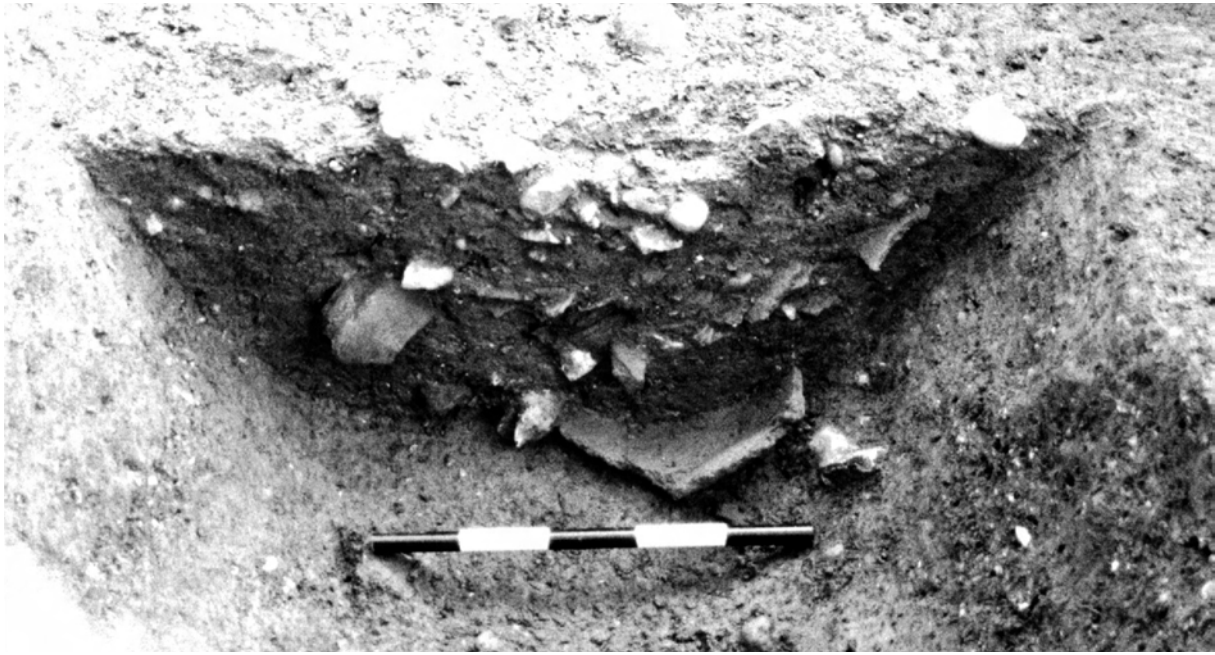

Plate 2 Trench 1, pottery in enclosure ditch section

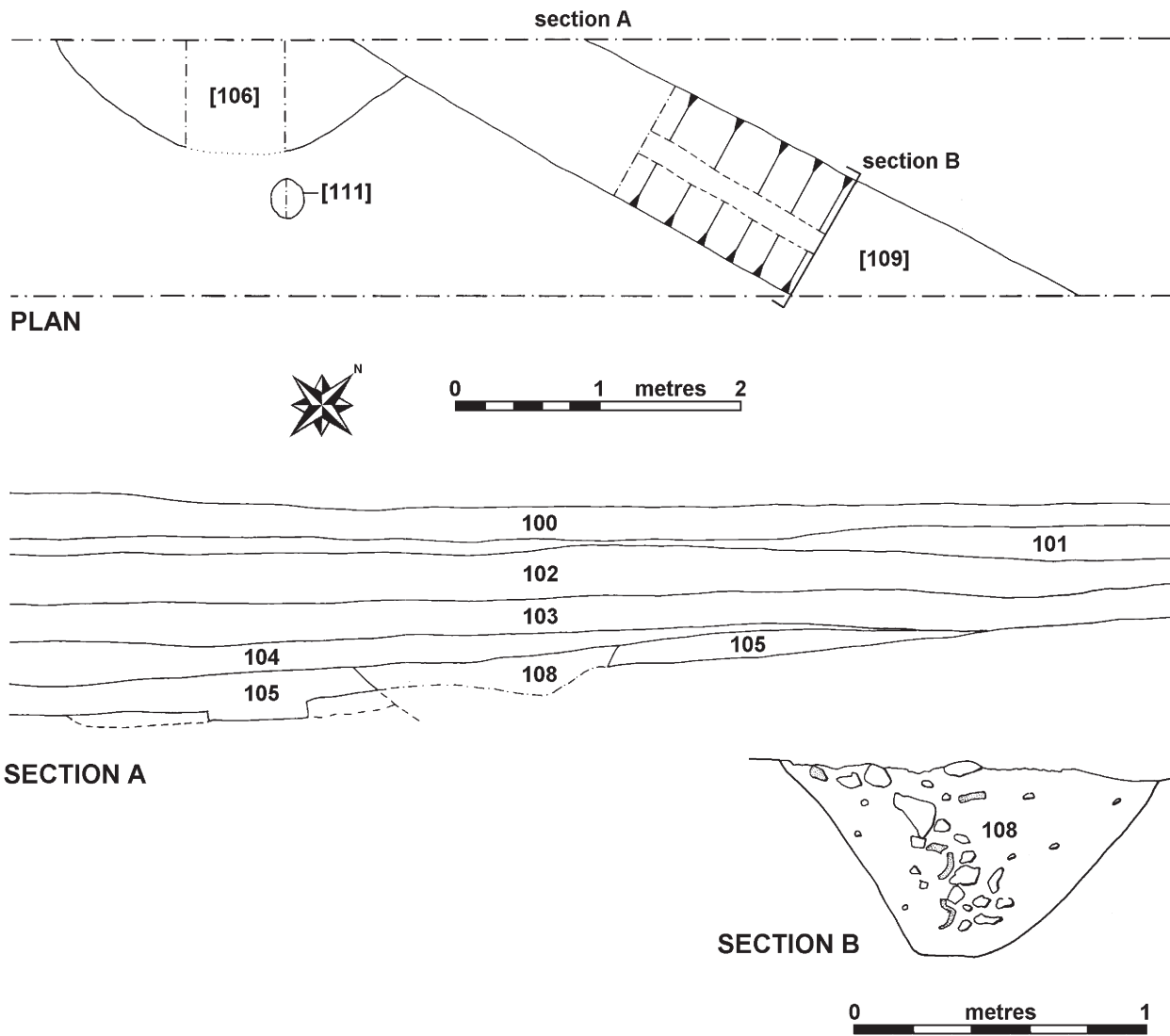

Fig 3 Trench 2, plan and sections

silty clay containing flints from 50-100mm in diameter and 218 sherds of pottery, amounting to 5.85kg. A fragment of clay loom weight or thatch weight was also recovered (Hunn, below: Fig. 7).

## THE POTTERY

Isobel Thompson

### The Assemblage

The pottery excavated in 1997 came from two segments of a trench across the enclosure ditch near its southern corner. That excavated in 1998 came from a second trench across the ditch, 2.5 m east of the 1997 trench.

The 1997 pottery assemblage was recovered from four contexts (013, 014, 022, 025), two in each of the two ditch segments excavated. Sherds from the same vessels were shared between 013 and 014, and between 022 and 025. There are also a few sherds in 013 and 014 which have every appearance of belonging to vessels from 022 and 025, although only one join could be made. The distance between the two segments was only 1.20m, so some sharing of vessels is feasible. It appears that all the pottery is a single assemblage, with the exception of some Roman sherds within 022. Since this is the top of the ditch fill some later contamination is likely.

The 1998 pottery came from Context 108, the fill of Ditch [109].

Nearly all the pottery was made in late Iron Age grog-tempered fabrics. Fabrics and weights are quantified in Table 1.

### The Grog-Tempered Fabrics

A certain range is discernible within the general category of grog-tempering, but it is not easy to divide the mass into useful sub-fabrics: what appears valid for one assemblage may be misleading for another, as each reflects local clays and firing temperatures, and also the degree of wear on

original surface treatment. A once-burnished surface may be worn away to produce a gritty feel. Most of the Stanborough vessels are wheel-made: one shows signs of having been made on a turntable, not a fast wheel, and at least one, an early form, is hand-made.

There are three easily recognisable variants of grog-tempering common to the sites in the area, including Stanborough:

- 1 The *standard native grog*, which is a grey, dark grey or grey-brown fabric with tempering of grog, a little sand, and some organic material. There is often an orange, pink or brown layer beneath the surfaces, which are also grey or grey-brown, and noticeably patchy in colouring on the exterior: areas of grey, brown, and buff or orange, often tooled or burnished. This patchiness is due to bonfire or clamp firings. The overall colouring of an assemblage is dark grey. The firing temperature is fairly low, although some vessels appear to be fired at a higher temperature than the pre-Conquest norm and are harder.
- 2 Vessels with *deliberately oxidised surfaces*, pale orange or pale red, and as evenly coloured as possible. These usually still have a grey core although the best will have a brown core; sometimes the exterior has not been a complete success and has grey patches, or is buff or pale brown. This fabric is used as a rule for copies of imported forms, butt-beakers, etc.
- 3 *Sandy grog*, a post-conquest addition of appreciable amounts of quartz sand to the grog tempering. The vessels have similar colouring and patchiness, but tending to a rustier brown and darker dark grey, and are distinctly gritty. Nearly all ordinary grog-tempering contains some quartz sand, usually in small amounts, but in the Verulamium-Welwyn area in the mid 1st century it is the deliberate and increasing addition of sand that marks a recognisable change in the fabric. Most of the Stanborough contexts contained at least one vessel in this distinctive fabric.

Table 1. Overall pottery quantification by weight

<i>Context</i>	<i>Grog (g)</i>	<i>Shell (g)</i>	<i>imported/RB (g)</i>	<i>fired clay (g)</i>
013	4,590	102	155	89
014	4,630	192	104	1,144
013/014	3,931	-	-	-
022	3,617	20	450	38
025	3,275	28	127	1,310
022/025	5,347	-	-	-
108	5,612	-	189	328
<b>Totals</b>	<b>31,002</b>	<b>342</b>	<b>1025</b>	<b>2,909</b>

Table 2. Minimum numbers of vessels in grogged fabrics, by context

<i>Context</i>	<i>standard grog</i>	<i>oxidised grog</i>	<i>sandy grog</i>
<b>013</b>	11	-	1
<b>014</b>	23	2	-
<b>013/014</b>	3	1	1
<b>022</b>	23	-	1
<b>025</b>	16	-	1
<b>022/025</b>	7	-	2
<b>108</b>	21	4	1

Table 3. Vessel forms found within each context.

<i>Context</i>	<i>Grog-tempered forms</i>	<i>Other fabrics</i>
<b>013</b>	C6-1 sherds C7-1, at least three (one in sandy grog) D1-1	shell: large jar base white pipeclay: sherds from a flagon pale red fine ware: ?Cam.91, rim & decor. fired clay: a little
<b>014</b>	C6-1, at least four, + sherds C7-1, three, + sherds D1-1, two D1-2 E3-1 G3-4 G5-6 base, + other sherds	shell: large jar base fine sandy: counter cut from sherd ?VRF: two scraps fired clay: substantial group, 'Belgic bricks'
<b>013/014</b>	C5-1 (in sandy grog) C6-1, two C7-1 G5-5	pale grey fine sandy, salmon-pink surfaces: base, handle and body sherds from a flagon
<b>022</b>	B5-5 C6-1, at least four C7-1, at least four E3-1 G1-1 G1-4	RB grey coarse wares: two rims, and sherds from a decorated carinated bowl, prob. 2nd century mortarium rim, 2nd century (?Northants) VRF: base, sherds red with cream slip: sherds TS: plain, one worn sherd fired clay: small amount
<b>025</b>	B1-1 (?D1-1) B5-5 C6-1 C7-1, at least three (one in sandy grog) G5-6, one or two sandy grog base	shell: two sherds amphora: mica coating, two sherds soft cream fine ware: butt-beaker sherds RB fine sandy grey: 3 sherds fired clay: substantial group, 'Belgic bricks'
<b>022/025</b>	A8 B3-10 ?C5-3 (sandy grog) C7-1, two D1-1, two G5-4 (sandy grog)	shell: (C5-2) rim
<b>108</b>	B3-1 (?B3-6) C6-1, two C7-1, at least seven E2-3, hand-made E3-5 G3-4 (probable) G5-5 G5-6 sherds sandy grog sherds	flint, sand, grog: hand-made container amphora sherd silty (?with some grog) butt beaker sherd cream sandy neck sherds fired clay : some

The minimum numbers of vessels in these fabrics in each context is shown in Table 2.

### The Forms

The forms found within each context are listed in Table 3: the classification of the grog-tempered pottery is taken from Thompson 1982.

**A8:** flat-footed pedestal urn. One (small), complete profile: sherds from Contexts 022 and 025. Not common, but examples are scattered across Essex and Herts, with a few known from Kent. They can be early or late, into the Roman period.

**B1-1:** everted rim with offset and cordon, which would

belong to a D1-1 or other more complete form. One, in Context 025.

**B3-1:** rim of an everted-rim jar with bulge between cordons on shoulder. It is wide-mouthed, and could belong to B3-6 which is the tall jar version very common in Herts. Known at the end of the 1st century BC in the Welwyn area, but can be post-conquest, and the matt finish (no tooling or burnish) of this rim from Context 108 is similar to others in the Verulamium area which can be as late as the Flavian period.

**B3-10:** very large wide-mouthed jar with cordons. One rim, in Contexts 022 and 025: compare Arnold (1952-4, no.1), a very similar rim from the same enclosure ditch, found in 1953. There are not many

- known examples, but they are a Herts-Beds form of the 1st century AD, known at Braughing and Prae Wood.
- B5-5:** globular barrel jar with cordon on the rounded shoulder. A complete profile of a small specimen in Context 025, and fragments, worn and broken up, of a second larger example in Context 022. The angle and size of the fragments in the latter indicate a globular vessel, not the tall version. The form, which is not common, is pre-conquest.
- C5-1:** plain lid-seated jar. One small example, with sherds in Contexts 013 and 014. Another previously found in 1953 (Arnold 1952-4, no.13). This is chiefly a Herts-Beds-Bucks form that is more commonly made with shell or sand temper than grog, and is often later 1st-century AD; the grog-tempered examples at Prae Wood and Verulamium are post-conquest.
- C5-3:** globular jar with dished rim and rilled girth. One possible example, the small jar in sandy grog from Contexts 022 and 025 with the leaf mark (below). It has lost its rim but appears likely to be this form, which is rare except at Prae Wood and 1st-century Verulamium.
- C6-1:** storage jars. Here all are the standard Herts form with everted rim and combing on the body, and usually with a horizontal combed wave pattern on the shoulder. Some are very large. All sites with grog-tempered pottery have these, often lasting into the 2nd century AD.
- C7-1:** coarse everted rim jars with rilled bodies. The most common form in assemblages of grog-tempered settlement pottery in Herts, the standard kitchen ware and often with signs of use in cooking.
- D1-1:** plain bowls with offset neck and often one cordon at the offset. This bowl form, with a rim diameter greater than the height of the pot, is standard in Herts, rather than the taller B1 jar varieties. It is known on early settlements at Braughing and elsewhere, and lasted for at least a century until it appears in Roman fabrics.
- D1-2:** as D1-1, but with an elongated neck. A variation with no difference in date. Only one here, in Context 014.
- E2-3:** cup with rounded profile and rippled neck. One, in Context 108; it is hand-made and primitive-looking, like many of this form. Rare in Herts, but known at Prae Wood and Grubs Barn; pre-conquest, and can be early.
- E3-1:** cup with cordon at offset below everted rim, the cup version of D1-1. A standard form in grog-tempering, which can last into the post-Conquest period. Early examples at Braughing and in the Welwyn chieftain graves, at Grubs Barn and Crookhams, and many at Prae Wood.
- E3-5:** cup with small narrow-mouthed everted rim and offset neck. One, from Context 108, nearly complete. A common form in grog-tempering, locally known in early levels at Braughing and in several contexts at Prae Wood: it can overlap the Conquest.
- G1-1:** straight-walled plate copying Gallo-Belgic form Cam.1. One example, in Context 022. The standard pre-Conquest plate form, but which can occur in post-Conquest contexts: many at Prae Wood.
- G1-4:** copy of Gallo-Belgic plate form Cam.4, large, splayed, with overhanging rim and inner moulding. The second plate in Context 022 seems closest to this form, which is generally unusual but common at Prae Wood: it appears just to overlap the Conquest.
- G3-4:** copies of Gallo-Belgic rounded cup forms. These grog-tempered copies are rare, but there seem to be two examples from the enclosure ditch, one from Context 014 and one from Context 108. Each copies a different form. The former is a large version of Cam.91, the imported original, globular beakers with small bead rim and incurved foot, which can occur in large sizes (Hawkes & Hull 1947, 234), and has bands of vertical combed lines exactly like the decoration of local butt-beakers, as well as an overall colour effect that may be an attempt at the 'chocolate' surface of the Cam.91 originals. The date at Camulodunum was AD 10-65. The Stanborough vessel has a close parallel in grave 366 at King Harry Lane (Stead & Rigby 1989, fig. 164), dated to AD 40-60. The latter example only survives in base and body fragments, but the shape, which has no cordons, its deliberate pale red surface colour imitating *terra rubra*, and stabbed decoration, all suggest a variety of Cam.108, a globular or ovoid beaker with everted rim and stabbed decoration. Cam.108 was 'an important local type at Colchester' from the Conquest period onwards, in romanising and then Roman fabrics (Hawkes & Hull 1947, 237).
- G5-4:** plain butt-beaker with offset neck. One example, from Contexts 022 and 025. Not nearly as common as the decorated version G5-5, but known mostly in Herts: there are a few at Prae Wood, and one from Crookhams. The shallow horizontal tooling is also found on G5-1 butt-beakers from Verulam Hills Field at Verulamium. In date the form just overlaps the Conquest.
- G5-5:** butt-beakers with offset neck and decoration. The commonest of butt-beaker forms, and the one that lasts longest, into the later 1st century AD. The fine-combed vertical decoration on the Stanborough specimens is normal for Herts, as at Prae Wood, and at Stanborough in 1953 (Arnold 1952-4, no.7). This appears to copy the decoration on white pipeclay butt-beakers from northern Gaul: many examples of both originals and copies were found in the King Harry Lane cemetery.
- G5-6:** butt-beaker fragments; here a single base, in Context 014, and sherds from other vessels.

### The Leaf Mark

Just inside the neck of the rilled jar of probable C5-3 form in Context 022/025 is the image of a small leaf, 13mm long and 8mm across at its widest (Fig. 6, 68). Examination with a ×10 hand lens and under a microscope indicates that it is not a real leaf but a deliberate mark, apparently representing a small bracken leaf. The outline and centre vein have been

cut into the surface of the clay before firing: it may be a freehand drawing or graffito, done with a finely pointed instrument. Alternatively, it might have been produced by a stamp, but it is quite different from the stamps used on the plates, mortaria and amphorae of the period. It is not within a rectangular cartouche or depression, so the original stamp would have been cut in relief, with the image standing clear. Secondly, its position inside the neck of the vessel means that it is not intended as decoration, which would be on the outside: nor is it in any of the easily visible positions used for name stamps or their imitations, on the rims of mortaria, handles of amphorae, or centre bases of plates. It is half hidden away, only discreetly visible.

It is hard to find parallels for this little mark, but there is one local instance and another possible. A mark in a similar position inside the neck of a jar has been recorded from the Wheathampstead by-pass (Saunders & Havercroft 1980-82, fig. 11.144). The site is only a few kilometres up the Lea valley from Stanborough. The jar is a B3 type with cordons and bulges, rare at Stanborough, but the mark is comparable, being the deliberate impression of a bracken leaf. It was described as a 'real leaf, pressed into the unfired clay'. A similar bracken leaf 'stamp' has also been noted on a vessel of comparable date from the King Harry Lane cemetery at St Albans (information from Miss V Rigby: *ibid.*, 29). The King Harry Lane mark is presumably that shown on burial 205, vessel 2 (Stead & Rigby 1989, fig. 127). It is also a bracken leaf, but is well down on the inside of the pot, nearer to the base than the neck, and might be accidental. It is not mentioned in the catalogue description of the pot, which is form B1-6. The date of the burial was in the region of AD 40-60, and this is comparable with both the Wheathampstead and Stanborough vessels. More examples of leaf marks may emerge in due course. Presumably they were the work of a local potter, and represent a practice not followed elsewhere.

The imitation name stamps on coarse wares at Braughing (Partridge 1980-82, fig. 10.16) and Baldock (Stead & Rigby 1986, 243) are abstract designs imitating lettering within elongated rectangles: others are known from Longthorpe (Dannell & Wild 1987, 128-30). A few stamps on fine ware in 1st-century London are almost leaf designs, but are outlined and are not realistic (Davies, Richardson & Tomber 1994, fig. 142.479, 814). The entire tradition of stamped decoration on Iron Age pottery (Elsdon 1975), and on the London/Essex stamped wares of the later 1st and early 2nd centuries (Tyers 1996, 169-71) is of linear patterns on the outsides of vessels: this leaf is a realistic image and apparently not meant to be decorative. The leaf may be intended as some sort of potter's mark: the sandy grog fabric indicates that it was made after the Roman conquest. The lid-seated jars from south Essex with numerals on the shoulder are more or less contemporary with the Stanborough jar, and others with similar marks are known at Milton Keynes (Marney 1989 fig. 24.5 & 6), but these are graffiti, not stamps, as is the mark on a rilled jar from Wheathampstead (Saunders & Havercroft 1980-82, fig. 12.155). Another incised mark is known on a storage jar from Gatesbury, Braughing (Partridge 1981, fig. 53.4) but this was added to the vessel after firing.

### Shell-Tempered Vessels

One or two vessels with shell tempering occur in most

Iron Age assemblages of any size in Hertfordshire, and Stanborough is no exception. It is likely that they are not always recognised: leaching of the crushed shell in the soil can leave the sherds with little remaining but voids, and they are often badly broken up. There is often some crushed shell to be seen, but such voids, and the consequent light weight of the sherds, are characteristic enough to be identifiable as shell tempering. The following vessels were found:

A rim in [022/025] that in grog would be form C5-2, a lid-seated jar with a slashed rim. The form is found in the Herts-Beds-Bucks area, usually in shell or sand-tempered ware, although some are found in grog, and was being made in Northants by the mid 1st century AD. Shelly examples are known from Prae Wood and Lockleys.

A flat jar base in Context 013, and another in 014. These are both from quite large jars.

### Fired Clay

Nearly 3.0kg of fired clay was present in the assemblage, the bulk of it in the primary fills (Table 1). Most, and possibly all of it, is what is known as 'Belgic bricks', with some substantial fragments included. Several fragments were part of a loom weight (described below). Other examples had already been noted in the 1953 assemblage.

### Catalogue of Illustrated Pottery (Figs 4-6)

A detailed catalogue of the 1997-98 ceramic assemblage from Stanborough is retained in the site archive. Only the more significant sherds are illustrated below.

#### Context 014 (Fig. 4)

##### Rims

- 1 D1-1 bowl, one large sherd, most of profile. Slightly hard pale grey core, very patchy dark grey-brown-buff surfaces, matt exterior. Neatly and precisely shaped with sharp angles, post-43 firing and finish. Dia. 150mm.
- 2 D1-2 bowl, two large sherds, joining, making up half the rim circuit. Dia. just under 140mm. Brittle grey, slightly hard fired; probably hand-finished rim, uneven wall thickness (very thin near base), and almost no cordon at the offset: a hurried line instead. Matt surfaces: grey streaky inside with buff at the neck, possible sooty patches in lower body; outside patchy buff-grey-dark grey.
- 3 G3-4 large cup. 7 sherds, all joining, dia. 150mm. Brittle thin slightly silty grey core with fine grog, mostly dark grey inside, buff patch near rim, more patchy dark grey-dark orange-buff outside. The rim line is irregular, but all the rest is very precisely shaped with faint vertical combing as on butt-beakers, all over; smooth surfaces.
- 4 D1-1 bowl, 6 sherds, joining, making about half the rim circuit: dia. 180mm. *There is one sherd in [013] which does not join but looks very similar.* Quite thick standard coarse grey, dark grey inside with dark brown towards the base, very patchy outside, dark grey to the girth and dark orange-brown below. Possibly some original tooling; broken around the vessel just under the offset.

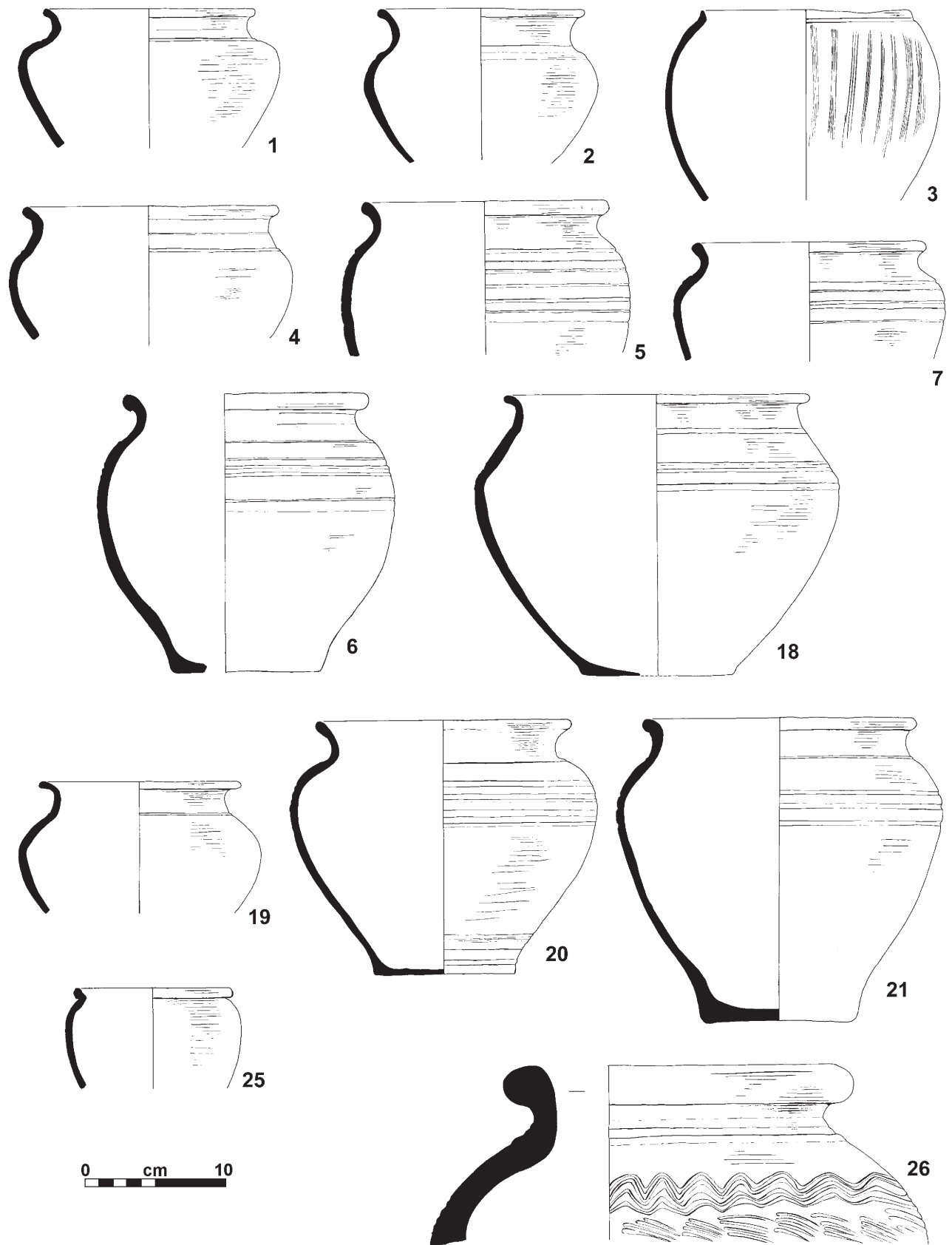

Fig 4 Pottery vessels 1-26 (scale 1:4)

- 5 C7-1 rilled jar. 4 sherds, joining, making up half the rim circuit: dia. 170mm. Hard slightly gritty grey, matt finish with much grog showing at the surface; dark grey inside, patchy dark grey to buff outside with orange-red patch and traces of black pigment or soot. Deep but quite hasty incised rilling. A coarse vessel.
- 6 C7-1 rilled jar. 22 joining rim and body sherds, 3 joining base sherds, and another 17 body sherds, making up quite a large vessel; more or less complete profile. Rim dia. 200mm, base 140mm. Underfired pale red-orange, fairly smooth but unevenly shaped pale orange inside, same colour all over; some of the same pale orange on the rim but lower exterior grey, patchy, crudely rilled and rusticated below. Traces of narrow holes drilled after firing in the base.
- 7 C7-1 rilled jar. Possibly hand-made. 3 sherds, joining to make up nearly half the rim circuit, just under 160mm dia. Quite soft grey, orange below uneven lumpy-contoured dark grey smooth inside, very patchy orange-dark grey outside: orange mostly on the shoulder, with grey patches on the rim, and smudgy dark grey on rusticated lower body.
- 8 C6-1 storage jar rim. One large sherd, dia. 330-340mm. No matching body sherds. Quite heavy and thick, dense coarse grey, some pink below evenly coloured smooth grey surfaces; a slightly unusual flat top to the rim. Not illustrated.
- 9 C6-1 storage jar rim. One not very large sherd, worn, dia. c.330mm. Coarse dense orange, orange smooth surface, worn darker brown-grey on inside. No matching neck or body sherds. Not illustrated.
- 10 C6-1 storage jar rim. 7 sherds, six of them scraps, joining: fragmented underfired coarse grey, dark grey smooth outside, worn inside, buff-grey patch on rim: dia. 320mm. Not illustrated.
- 11 Everted scrap, slightly dished: good fabric, neatly made: grey-brown with smooth dark grey surfaces. Dia. 140mm. Not illustrated.
- 12 Everted scrap, slightly sandy brown with dark grey surfaces, neatly made. Dia. 130mm. Not illustrated.

#### *Bases*

- 13 Joining sherds, more than half the circuit, of a neatly made small jar base with rounded walls: dia. 70mm. Possibly hand-made. Soft dark grey, uneven brown-grey inside, lumpy-surfaced very dark grey outside, evenly coloured and distinctively dark. Not illustrated.
- 14 G5-6 butt-beaker base, three sherds, joining. No matching body sherds. Good grey fabric, dark grey surfaces, well finished although not burnished. Dia. 100mm. Not illustrated.
- 15 Jar base, one sherd, nearly flat. Dia. ?110mm. Quite hard coarse grey, dark grey inside, grey-orange patchy outside, coarse matt finish. Not illustrated.
- 16 Scrap, probably from a C7-1 rilled jar base. Standard grey-brown, coarse and soft, with dark grey outside: no dia. Not illustrated.
- 17 C6-1 storage jar base, four large joining sherds. Dia. 190-200mm. Coarse brittle grey, fairly smooth inside walls with rougher surface to upper side of base, dark grey without spalling, more brown-grey higher up: rough orange-buff outside with dark

grey-black patches, faint combing. Large, hard, heavy. Not illustrated.

#### **Context 013 (Fig. 4)**

##### *Rims*

- 18 C7-1 rilled jar. Complete profile, with much of the vessel present. Complete base circuit, 100 mm dia.; most of the rim, 210mm dia.; one very large sherd, and 44 others, some small. Grey fabric, a little sand, not hard fired; some brown below brown slightly patchy smoothed inside, darker towards the base, matt outside, shallow neck cordon just a tooled line, rilled below, horizontal wiping, rusticated below girth, where it is orange-brown with dark grey at the base. Neat but rather summary rim.
- 19 D1-1 bowl. Profile complete except for centre of base. A wide sharply curving shape, shattered into 38 sherds, many small. Rim dia. 140mm, base 80mm. Underfired pale grey coarse fabric, evenly coloured mid-grey surfaces, smoothed and originally tooled outside and over the neat flaring rim.
- 20 C7-1 rilled jar. Complete profile, although the surviving sherds do not quite join. Complete rim circuit (180mm), half the body, and half the base (90mm), made up of 50 sherds, some small, plus five more with a black sooted interior that may belong. Sandy grog, very gritty: grey with dark grey-black smooth inside, brown inside rim, patchy dark grey-brown outside with all-over rilling and matt gritty shoulder. Neatly shaped but has suffered in use, with some dark orange worn patches on lower body and blackened interior.
- 21 C7-1 rilled jar. Complete profile: part of rim and shoulder (rim dia. 190mm), and complete base (100mm). 23 sherds, much of body missing. Soft coarse grey, brown inside base, black sooted lower interior, slightly lumpy grey upper interior; dark grey lumpy soft outside rim and shoulder, buff-orange lower body, soft rilling, rusticated below. Like all these, a neat rim. Thick base, turntable lines on under side, rusticated.
- 22 Bead rim, one sherd, with round shoulder and no neck; not large, but form and fabric are identical to Vessel 47, which is just as worn, and this sherd may belong to it. Grey fabric, orange-brown worn interior, dark grey worn outside, orange rim bead. Not illustrated.
- 23, 24 Grey grog beaded rim scraps, apparently but not certainly different vessels. Not illustrated.

#### **Contexts 013/014 (Figs 4-5)**

##### *Rims:*

- 25 C5-1 lid-seated jar. Two sherds, joining, one from each context. Dia. 110mm. Hard sandy grog, small and neatly shaped, dark grey core, orange to brown inside, dark grey-black outside, possibly once tooled.
- 26 C6-1 storage jar: 15 sherds from [014], 2 from [013]. Very large, dia. more than 320mm; dense solid dark grey standard grog, part of interior pale red and part grey, outside also very patchy, rapid deep combed decoration. The rim has shattered.

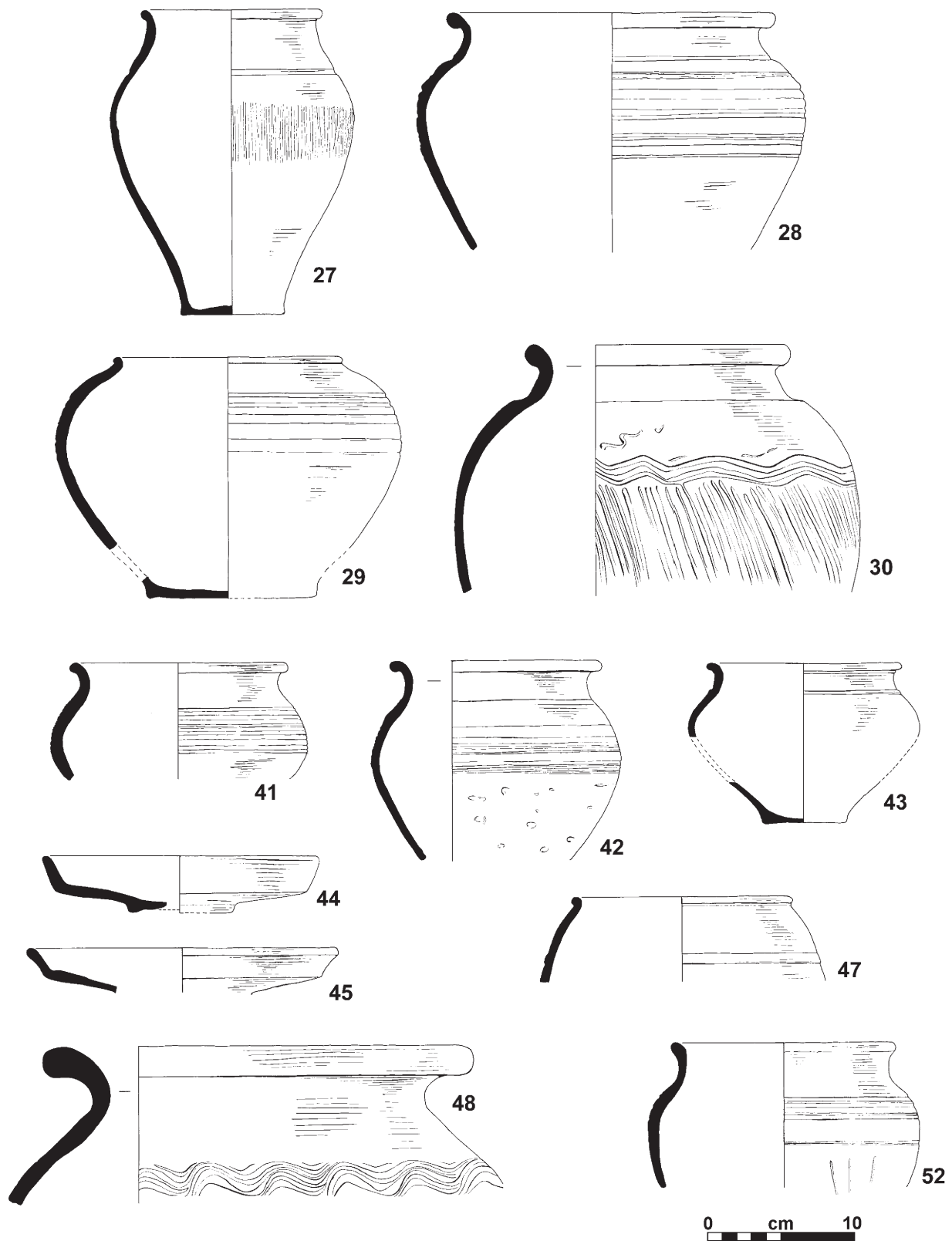

Fig 5 Pottery vessels 27-52 (scale 1:4)

27 G5-5 butt-beaker, with offset neck and decoration. Complete profile: 22 joining sherds and 4 others, plus one doubtful. Two small rim sherds, joining the rest, from [013], and all the others from [014].

About half the rim circuit survives (120mm dia.); base, complete, 73mm across. Fairly hard grey fabric, patchy hard brown-grey surfaces apparently with some attempt at making it look pale brown, but

not the oxidised pale red. Tooled but not burnished exterior; rough groove at offset and lack of cordons below; faint vertical butt-beaker combing. Not a well-made pot although the rim is neatly shaped: the butt-beaker form lacks conviction, producing something like a plain jar which retains butt-beaker features. Some spalling to pale orange inside the neck, with visible red grog.

- 28 C7-1 rilled jar. 19 sherds from [013] and 6 from [014], joining, plus another 4 lower body sherds, with heavy sooting, from [014] that may belong. Large sherds; most of rim circuit (dia. 220mm) survives and most of the shoulder: no base and not much of the lower body, although they provide most of the profile. Quite hard dense grey fabric, grey smooth interior, burnt black in lower half, outside patchy dark grey/grey-buff, red-buff towards the base: neat well-shaped rim and poor rusticated base half, like many of these rilled jars. Deep cut rilling, no tooling.

### Context 025 (Fig. 5)

#### Rims:

- 29 B5-5 barrel jar, complete profile. Rim dia. 150mm, base c.110mm. 37 sherds; a lot of joins, but the rim is in three or four non-joining pieces. Softish thick coarse grey fabric, some quartz lumps and a slightly gritty feel. The base does not join but shares the distinctive colouring and seems most likely to be part of this vessel: pale orange interior, with inside of rim slightly tooled to a redder colour, and outside mostly dark grey to brown-grey but with part of the exterior much paler. Lots of thick grog; brown sandwich below the dark grey parts of the exterior. Shallow rilling on girth. Very neat rim, but the remainder fairly slapdash.
- 30 C6-1 storage jar. One very large sherd, with four small sherds recently broken from it, dia. 260mm. Thick coarse darkish grey fabric, much temper, with red grog visible on interior surface: brown beneath dark grey inside, worn especially near the rim, and quite good darkish grey outside. Brittle, not underfired, good shaping and combing: buff-orange patch on rim. Base 36 may belong.
- 31 B1-1 everted jar rim, one sherd of medium size, dia. 170mm. Slightly gritty grey grog, pale grey worn inside, dark grey outside, neat but not burnished. Not illustrated.
- 32 C7-1 rilled jar rim; two sherds, joining. Dia. 180mm. Gritty grog, but not enough sand to make it the sandy grog fabric: grey-brown core, dark grey surfaces, deep irregular rilling, some tooling on neck. Not illustrated.
- 33 C7-1 rilled jar rim, one sherd. Dia. 170mm. Quite hard dense pale grey, pale brown and patchy grey inside, smoothed, and dark grey outside, sooted rilling. Some sand, but in fact the standard grog fired quite hard. Not illustrated.

#### Bases

- 34 Nearly half of the base of a jar with rounded body, dia. 70mm, quite small and neat. Possibly hand-made, or at least made on a turntable. 5 joining

sherds, and another six probably belonging. Quite gritty grey grog, but not yet the sandy grog fabric; hand-finished dark red-brown inside, dark grey outside around base and much paler buff-red higher up the pot, with traces of wiping around the surface. *Plus one more sherd, joining, from [022], so really belongs below.* Not illustrated.

- 35 Plain jar base, three joining sherds and one extra, dia. c.80mm although slightly irregular. Wheel marks on fairly distinctively coloured internal surface; quite soft thin grey fabric, pinky brown below pale grey-buff inside, showing red grog, and wiped smooth: darker grey-brown outside, slightly wiped but less well done than on the inside. Not illustrated.
- 36 Storage jar base, 20 sherds remaining, some large, mostly joining. Dia. c.160mm. Slightly hard brittle grey grog, pale orange thick sandwich below very dark grey wiped interior showing red grog, spalled and worn; red-brown outside, more red near the base, roughly combed. Not illustrated.
- 37 One sherd of the base of a jar with flaring lower body, more flared than a butt-beaker, dia. 100mm, in sandy grog: hard, gritty, grey with lumpy orange-dark grey inside and wiped grey-brown outside. Not illustrated.
- 38 One sherd from the base of a jar in good ordinary grey grog, quite thick, orange below grey-brown surfaces, smoothed, slightly darker outside. Some red grog shows on inside surface. Worn and chipped; dia. 140mm. Not illustrated.
- 39 One sherd, thin ordinary grey grog, which is irregularly shaped and hard to classify; possibly from a pedestal, originally luted on, but with no real sign of attachment; or an omphalos, but probably too wide at 90mm dia. Untooled grey-brown inside and dark grey smooth outside, worn all over underside. Not illustrated.
- 40 Fragment of a C7-1 rilled jar base, combed, in coarse softish grey. Not illustrated.

### Context 022 (Fig. 5)

#### Rims

- 41 C7-1 rilled jar. 4 sherds, joining, making up half the rim circuit; dia. 145mm. Grey grog, quite fine temper, evenly coloured pale grey inside, patchy orange-dark grey outside, deep incised rilling, lower body possibly knife-trimmed, rougher finish: smooth neck, but no tooling, matt finish.
- 42 C7-1 rilled jar. Two sherds, both large, not joining but appear to be the same vessel. Dia. just over 200mm, so a wide-mouthed pot. Very slightly sandy grey grog, quite thin, pale brown smooth inside with a dark grey patch, dark grey outside and more brown towards base: neat shaping, fairly shallow neat rilling, ?knife-shaped below, rusticated with holes and marks dragged across the surface.
- 43 E3-1 rounded cup with everted rim and offset, complete profile. Ten sherds, partly joining: rim dia. 130mm, base only 60mm. Grey grog, grey-brown-buff over pale orange, darker grey inside worn away, worn grey outside once more grey than the orange shade it now carries.
- 44 G1-1 plate, one sherd, most of profile. Rim dia.

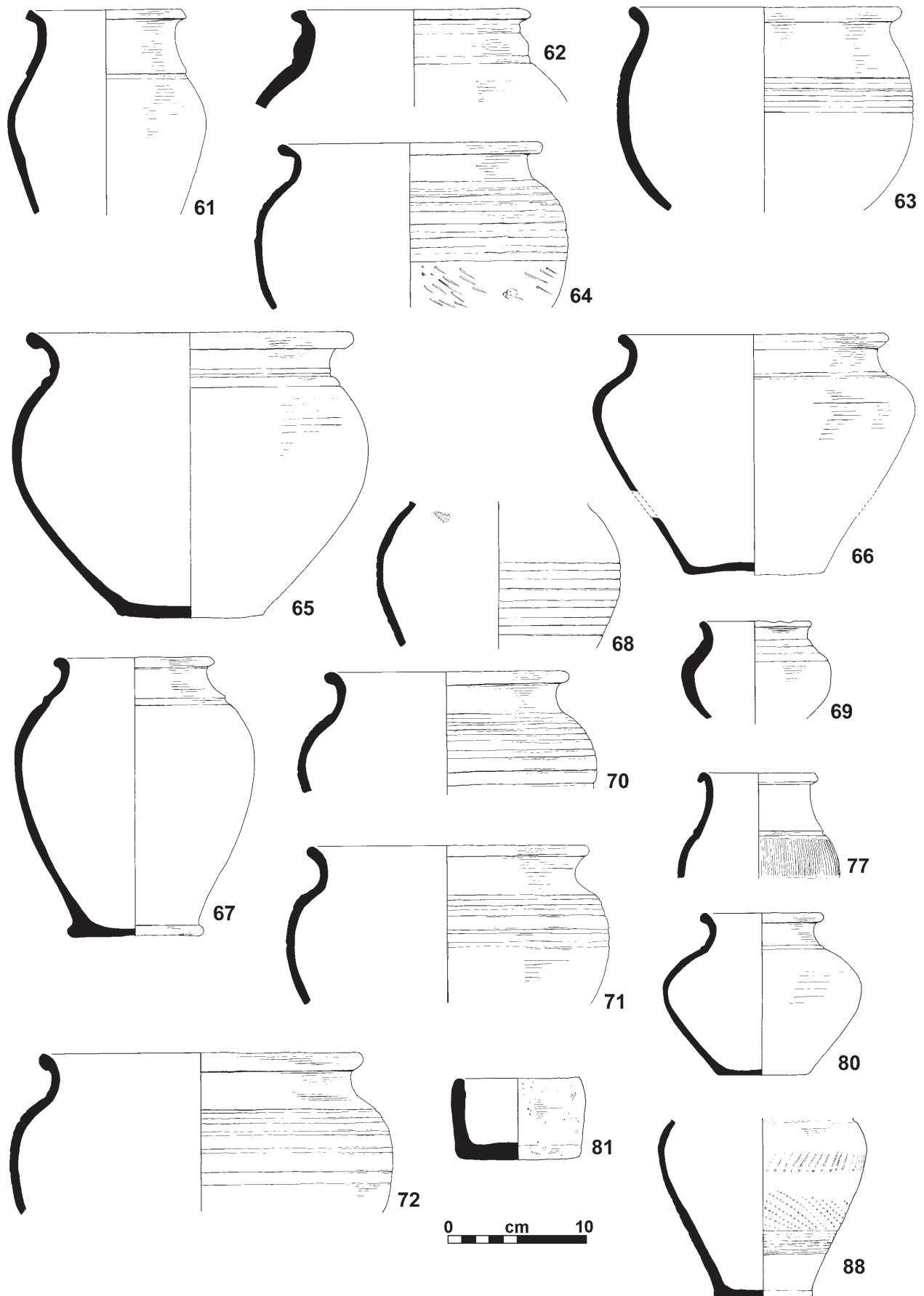

Fig 6 Pottery vessels 61-88 (scale 1:4)

- 190mm, base c.80mm. Fairly coarse grey grog, quite thick and substantial pot with slightly gritty feel, dark grey surfaces, tooled apparently all over although upper surface is a bit worn.
- 45 G1-4 plate, seven sherds, joining, dia. 210mm. Footring missing. Slightly sandy grey grog, brittle and easily broken, hard tooled grey surfaces with slight buff patchiness: precise shaping.
- 46 C7-1 rilled jar, one sherd, plus two possibly belonging. Good ordinary dark grey-brown grog, softish, medium grey evenly-coloured fairly smooth inside, patchy grey-dark grey-buff outside, quite shallow rilling, plain offset, no tooling. Dia. c.140mm. Not illustrated.
- 47 B5-5 barrel jar: six sherds, only two joining, the surviving bead rim only a scrap but dia. may be c.150mm. No evidence of more than one cordon. Soft coarse grey-brown grog, orange below originally darker grey-brown surfaces, much worn and pitted on inside through to the grey core, outside the grey original surface only partly surviving. Once tooled and may have been quite a good pot; neat plain rim and cordon, which indicates a wide dia. There is a plain sherd in [014] which has a very similar fabric and colouring, and a vessel in [013] is also the same fabric: these may belong to this vessel.
- 48 C6-1 storage jar, four sherds, joining, of a large heavy rim; dia. much larger than 320mm. Mainly brick-red dense grog, smooth brick-red inside surface, dark grey over rim, where coarse grog shows in the break; patchy dark grey-orange outside, deep swirling combed decoration. Neatly done, hard smooth surfaces.
- 49 C6-1 rim, one sherd, dia. 310mm. Coarse slightly gritty grey grog, smoothed dark grey surfaces; flaring profile. Not illustrated.
- 50 C6-1 rim, one quite small sherd, dia. c.300mm. Coarse quite pale grey grog, pale orange-buff worn inside, and top of rim; darker grey outside, slightly rough. Not illustrated.
- 51 C6-1 rim, one rim sherd and three joining lower body sherds (not joining the rim). Thick coarse grog, soft brick-red all through except just at top of rim where it is grey. Dark grey smoothed outside, usual combing on body, worn lumpy red inside, original interior surface long gone. Dia. over 320mm. Not illustrated.
- 52 C7-1 rilled jar. Three joining sherds and two others likely to belong. Brittle ?underfired sandy grog, dark brown-grey core and surfaces, patchy dark colours. Dia. c.150mm. One of the non-joining sherds joins one in [013], and [013] also has a rim sherd which looks very similar, so all put together here.
- 53 Everted rim, two sherds, joining, dia. 180mm. Ordinary grey-brown grog, darker grey surfaces, smoothed. Not illustrated.
- 54 Rim fragment, one small sherd, dia. 150mm, slightly flat-topped; ordinary softish grey-brown grog, pale orange below grey-brown inside, smoothed, and darker grey outside; much red grog shows in worn rim surface. Not illustrated.
- 55 Bead rim fragment, slightly gritty feel, grey grog with slightly darker grey surfaces. No dia.. Not illustrated.
- 56 Everted rim fragment, dia. ?200 mm; fairly pale

grey grog, grey-brown inside surface and no original outside surface; slightly leached. Not illustrated.

#### *Bases*

- 57 C6-1 storage jar base, 7 joining sherds and 13 others (some small). Dia. 160mm. Coarse grey grog, large pieces of temper, pale orange outside and pale brown inside; underfired and worn, base has laminated in part. Two surviving holes drilled in base after firing, but there does not appear to have been a central hole: perhaps four in all. One sherd may be from higher up the body, thinner, combed, but no combing in lower wall. Not illustrated.
- 58 Jar base, three sherds, joining, ordinary quite pale grey grog, brown surfaces, worn inside and darker on outside with some wear to orange-brown: dia. 110mm. Not illustrated.
- 59 One quite small sherd from a thick jar base, sandy grog, dark grey, slightly brown inside and red outside: worn. Dia. c.110mm. Not illustrated.
- 60 C7-1 rilled jar base, three sherds, two joining; soft grey-brown, no remaining inside, soft battered outside; dia. 90mm. Not illustrated.

#### **Contexts 022/025 (Fig. 6)**

#### *Rims*

- 61 G5-4 butt-beaker, plain with offset neck; almost complete profile, and more than half the rim circuit (dia. 110mm). 23 sherds from [025], 11 sherds from [022]. Sandy grog, thin, grey-brown; slightly browner and grittier on inside than on outside: some shallow tooling on outside, darker grey. Plain, no real burnish.
- 62 B3-10 jar rim, large, thick; dia. 260mm. 3 sherds from [022] and 4 sherds from [025]. Distinctive quite pale grey grog, dark grey wiped smooth inside, some remains of similar dark grey outside but mostly worn to a paler grey; some sherds are from lower down the body, with a very little shallow combing. No burnish, large and very neatly shaped, heavy and hard fired.
- 63 C7-1 rilled jar, dia. just over 200mm. 25 sherds from [022] and one from [025]: many joins, and over half the rim circuit although not all joining together. Grey grog, not over hard, brown inside with some red grog showing, very patchy dark grey-brown outside, dark grey rim, black patches on girth, more orange below, shallow rilling, shallow neck and shaping; globular shape to the whole vessel. Irregular hand-shaping on lower interior.
- 64 C7-1 rilled jar, dia. 190mm: half the rim circuit, but broken into four large pieces and many small ones. 27 sherds from [022] and 3 sherds from [025]. Lumpy grey grog, some red grog showing in grey-brown wiped smooth inside, dark grey near base, patchy dark grey outside, quite rough shaping. Softish and coarse.
- 65 D1-1 bowl, complete profile: complete rim and much of base, and possibly only part of the lower body missing. Rim dia. 230mm; base dia. 110mm. 44 sherds from [022], joining, and 4 sherds from [025]. This pot is at least partly hand-made, or done on a turntable: the rim has partly sagged. Soft grey

- grog, thickest at flat base, very patchy colouring, brown-grey inside with sooty deposit around sides, although not inside the base itself: outside mostly dark grey rim and shoulder, worn tooling, and lower body worn to orange-buff. Good plain shape, solid rim, but hurriedly made, and worn: possibly underfired, especially around the base.
- 66 D1-1 bowl, apparently complete although in many pieces. 19 sherds from [025], 2 base sherds from [022], all joining. Rim dia. 190mm, base 90mm. Fairly hard grey grog, several obvious large quartz pebbles up to 2mm across, but not a sandy grog fabric. Quite evenly coloured pale brown inside, patchy brown-grey outside, large dark grey patch, also a browner patch: neat but plain shaping and no tooling or burnish, a plain matt surface. Uneven wall thickness, thin but in part quite thick and the shoulder. Firing has made it fairly brittle. Base is discoloured dark grey on underside. Some wiping marks and voids in outside: made to a neat shape but no attempt to finish off the surface.
- 67 A8 pedestal jar with flat base. Whole profile, joining; much of neatly shaped rim and shoulder, and some of the base, but soft, partly spalled on inside, and much broken up. 42 sherds from [022] and 6 sherds from [025], all joining. Soft ordinary grey-brown grog, dark grey surfaces, patchy outside with more buff colouring but underfired in part, spalled away on inside and outside, now crumbling. Inside of base has worn away; rapid wiping on lower inside, tooled shoulder on outside. Rim dia. (not quite complete circuit) 130mm, base 90mm.

*Decorated:*

- 68 Probable C5-3 jar with leaf mark: most of the profile, but lacking the rim itself, and the base. 8 sherds (seven joining) from [025] and three (one joining) from [022]. Sandy grog, distinctive, with grey core, red-brown sandwich below patchy dark grey-brown surfaces, gritty, no tooling. Centre of girth is rippled, with tooled rilling below all the way down. The leaf mark is hidden inside the neck, and is 13mm long and 8mm across at its widest: very neatly done.

**Context 108** (Fig. 6)

*Rims*

- 69 E2-3 cup, hand-made, in three joining pieces making up three-quarters of the profile. Dia. 80mm: a small and primitive vessel, ripple-necked. Thick slightly gritty grey grog, dark grey-black surfaces probably tooled (or some black pigment) on neck, wear below girth and orange patch: inside unfinished, black sooting below girth, brown-orange above.
- 70 C7-1 rilled jar. One large sherd, dia. 170mm. Very neatly made, fairly hard grey grog, darker grey smooth surfaces, even darker outside, neat precise rim and rilling.
- 71 C7-1 rilled jar. 11 sherds, joining, making nearly half the rim circuit, more of the shoulder, and some of lower body; dia. 200mm. Coarse perhaps underfired grey-brown grog, enough sand to feel slightly gritty, brown inside, dark grey-black rim and shoulder,
- 72 C7-1 rilled jar. Three large sherds, two small, all joining, and one large sherd possibly belonging; dia. 230mm, a large pot. Underfired dark grey-brown grog, slightly gritty, some pink below smoothed grey-brown inside, brown neck with traces of black pigment, dark grey rim and girth, dark grey-brown below; shallow rilling, some rustication.
- 73 C7-1 rilled jar. Two small sherds, joining, and two more with similar interior colouring that may represent the lower body, rilled. Grey grog, pale brown inside with grey at rim, dark grey outside, neat rim and rilling. Dia. 220mm, but not much represented. Not illustrated.
- 74 C7-1 rilled jar. Three small sherds, two joining, dia. 170mm. Quite soft ordinary dark grey grog, dark grey smoothed surfaces, fairly neat rilling; a good rim. Not illustrated.
- 75 C7-1 rilled jar. Three smallish sherds, joining, dia. 230mm. Coarse softish pale grey grog, large grains of temper, fairly pale grey patchy surfaces, some darker patches, smoothed matt finish, shallow rilling. Not illustrated.
- 76 B3-1 jar. One sherd, dia. 250mm; slightly sandy pale grey grog, pale buff inside, dark grey at rim, orange outside, post-conquest matt finish. Not illustrated.
- 77 G5-5 offset-neck decorated butt-beaker. Two sherds, joining, dia. 80mm; and two extra from lower body which probably belong. Slightly sandy thin grey grog, dark grey surfaces, undercut rim, vertical combed 'rouletting' on outside: possibly once tooled but now matt on neck.
- 78 C7-1 rilled jar. Two sherds, joining, thin, worn and dirty. Dia. c.100mm. Thin grey-brown grog, brown body, grey neck and rim, worn to orange-brown at rim: rilling not well done. Not illustrated.
- 79 C6-1 storage jar. One rim sherd, very worn, dia. c.340mm: coarse grey grog, no remaining inside surface, outside once dark grey. Not illustrated.
- 80 E3-5 cup. Nearly complete but broken up: complete rim and base circuits. Rim dia. 90mm, base 60mm, 20 sherds. Quite a narrow rim: ordinary grey grog, brown below grey-brown slightly patchy surfaces, thin and fairly well made, probably originally tooled.
- 81 [no form] Three sherds, joining, not quite making a complete vessel: a hand-made, thick, flat-based and straight-sided small container, the rim very slightly turned in. Rim dia. 90mm, base 80mm, thick dark grey-brown with some grog and fine quartz sand, and many large fragments of coarsely crushed stones including flint. Brown inside smoothed off with the fingers: on the outside and under the base the clay has been wiped smooth over the coarse tempering. There is no residue inside the vessel and it is the wrong shape for a crucible: it may have had a particular purpose or function but there are no indications of what this may have been.
- 82 Everted rim above offset. Three sherds, joining, small. Dia. c.210mm. Hard grey slightly gritty grog, pale hard surfaces, buff-grey, probably once tooled to a slightly darker colour but now worn. Not illustrated.
- 83 Hooked everted rim, one small sherd, dia. 180mm.

Good ordinary grey grog, grey-brown inside, tooled dark grey outside. Sherd slightly worn at edges. Not illustrated.

- 84 C7-1 rilled jar. Two small sherds, not joining but fairly certainly the same vessel, and do not appear to belong to any of the other rilled jars. Grey grog, orange-brown below worn brown inside, slightly lumpy very dark grey outside, quite soft. Dia. c.190mm. Not illustrated.
- 85 Everted rim scrap, dia. c.160mm, and four other sherds that appear to belong: softish grey grog with deliberate pale orange surfaces, soft and worn; not the best original finish, and not as thinly potted as the best *terra rubra* copies. Not illustrated.

#### Bases

- 86 A probable rilled jar base, more than three-quarters complete, one sherd, dia. 90mm. Thin, coarse but quite neatly made, grey grog, brown upper surface, black interior walls, dark grey rusticated underside with wheel marks, orange-grey patchy outside. Not illustrated.
- 87 Fragment of a coarse jar base, dark grey-brown, not large, thicker than 86. Not illustrated.
- 88 G3-4 copy of an imported fine ware form: seven base sherds, six of them joining, dia. 70mm, and another six sherds from upper body, some joining, but not to the base: fabric and decoration the same. Grey grog, deliberate pale red surfaces, slightly sandy feeling, worn inside, some grey patches on outside: decoration of lines pierced by the teeth of a comb and some larger pierced dots, between tooled bands. This was once a good vessel but is very worn and battered.
- 89 Two sherds, joining, from a copy of another fine ware form, dia. 88mm. Pale grey grog, deliberate pale red surfaces, matt finish: rather grey in tone on outside. Late fabric. Not illustrated.
- 90 One sherd, worn, from a coarse flat jar base: dia. 130mm. Slightly hard brittle dark grey grog, pale grey-buff inside, patchy grey-buff outside, no tooling, roughened. A bit large for a rilled jar and small for a storage jar. Not illustrated.
- 91 Joining sherds making a complete base, and 15 other sherds that may belong: dia. 100mm. A large coarse base, grey grog, thick red sandwich below red fairly smooth inside, patchy brown-red-dark grey outside: the extra sherds have same fabric and even browner outside, and combing similar to larger storage jars. Not illustrated.

## CONCLUSIONS AND DATING

The first observation to make is that joins and specific similarities between sherds in the different contexts suggest that all the grog-tempered pottery may be considered as a single assemblage. This assemblage includes unusually large numbers of complete or nearly complete profiles, and few left-over body sherds. Lack of wear of the sherds is also noticeable. These two factors indicate that the assemblage arrived in the enclosure ditch not as a gradual accumulation of rubbish, but as the result of what might be termed a *single deposit event*: it was all dumped at the same time. For whatever reason, the vessels had reached the end of their usefulness.

The likely date of this event will be considered below, but it should be noted first that this does not, of course, date the manufacture or period of use of the vessels. The range of forms is that of a standard domestic assemblage of the first half of the 1st century AD in Hertfordshire, dominated by cooking and storage jars, with plain bowls and butt-beakers, some cups, and some copies of imported fine wares more unusual than the ubiquitous butt-beakers. Their presence indicates a comparatively wealthy and well-connected settlement with access to a major centre where such vessels were obtainable, such as *Verlamion*. Some of the forms (G1-4, C5-3) are characteristic of Prae Wood/Verlamion assemblages, and the G3-4 globular cup in 014 is a rare form with a striking parallel in the King Harry Lane cemetery. These vessels and the leaf mark indicate a close relationship between the Stanborough site and the hinterland of Verlamion. At the same time, the range of forms is small: there is a noticeable lack of B1 and B3 jars, carinated cups, and bowl forms other than the plainest. The Stanborough vessels are nearly all neatly made but are noticeably plain, with little obvious effort to finish them with tooling and burnish. This too is a trait common in *late* grog-tempered assemblages in and around Verlamion.

The dating of these forms is not easy to establish, as so many of them can range from the later 1st century BC to the late 1st century AD or even later. Several of them (the C5-1 in 013/014, the two G3-4 examples in 014 and 108) indicate a Conquest-period date, in the middle of the 1st century AD. On the other hand there are one or two (the two examples of B5-5 in 022 and 025, the hand-made E2-3 cup in 108, and perhaps the odd hand-made container in 108) which are likely to have been made considerably earlier. The general appearance of the assemblage is that of pots which have accumulated within the settlement over several decades from early in the first century.

The fabrics are entirely consistent with the range of forms. Much of the pottery is in standard native grey-brown grog, some of which is underfired and comparatively soft. But it also includes one base in hard grey grog that looks post-Conquest, and several vessels in the sandy grog. There are a few with signs of a distinctive matt finish, without tooling or burnish of any kind, which in the vicinity of Verulamium was used for plain grog-tempered forms after the Conquest and is found in Flavian ditch deposits.

Therefore, the date of the deposit of this assemblage in the enclosure ditch is certainly after the Roman Conquest. The latest date for the assemblage, and therefore the date of the deposit, is difficult to estimate, as it is not really clear how native pottery overlapped with Roman forms and fabrics outside or inside the main centres. True Romano-British pottery products are scarcely present in the assemblage: rather, the non-grog and -shell fabrics appear to be mid 1st-century fine wares, some imported. There is some Roman pottery in 022, but it is 2nd century in date and represents contamination at the top of the ditch fill.

The pottery retrieved in 1953 (Arnold 1952-4) is entirely comparable with the 1997-98 assemblage. It came from trenches across the same enclosure ditch, the nearest only a few metres from Trench 2. The 1953 vessels are characterised by whole or nearly whole profiles, a similar small range of plain forms, one or two of them early, and the presence of a small amount of sandy grog. Also present were a clay weight (below, Fig. 7), a few fragments of Roman brick and

tile, and some 'Belgic brick' fragments, which are thought to be kiln furniture. The one surviving vessel from the 1938 work also had a complete surviving profile: it came from the same ditch, but on the opposite side of the enclosure, and from the same part of the ditch came a La Tène III brooch and a coin of Claudius.

Therefore, at some time after the Roman Conquest in AD 43, but perhaps not later than the start of the Flavian period in AD 69, a considerable quantity of domestic pottery was taken from an adjacent settlement and used to fill up the ditch. This ought to mean that all this material was no longer needed for domestic use. Some of it may have been several decades old, but possibly recently still in use, when it was dumped. It is noticeable that the pottery found in 1997/98 and in 1953 was concentrated around the southern corner of the enclosure ditch, whereas the main 1953 trench, along the eastern length of the ditch, was barren. Such concentrations in ditches have been found on many sites of the period in Hertfordshire, at Prae Wood and Folly Lane at Verulamium, and elsewhere. At Folly Lane the reason was certainly clearance of domestic buildings prior to the construction of the ceremonial enclosure (Niblett 1999), and in general such dumps of grog-tempered pottery, in the middle years of the 1st century, are on sites where there is no obvious continuation of settlement. Roman material occurs, but is usually in small quantities and in small scraps. At Stanborough the few Roman sherds from the top of the ditch and at least one of the burials indicate occupation here in the 2nd century, but the pottery in the enclosure ditch demonstrates the deliberate termination of the late Iron Age occupation in the middle of the 1st century. The dislocation of the Boudiccan revolt, and the attraction of settlers to the new town of Verulamium, are two major reasons for the change in settlement pattern,

although there could be other causes of a more personal nature, not now recognisable, of the abandonment of the Stanborough enclosure and its like.

### Clay Weight (Fig. 7)

J.R. Hunn

Triangular fired clay weight: reconstructed measurements 185mm at its base, 80mm thick and about 200mm in height. There were two surviving holes for cords at its base and one two-thirds of the way up, with another one missing. It appears to be considerably larger than the loom weight referred to by Arnold (1952-54, 128), which he states was similar to the one found by Wheeler at Prae Wood (Wheeler & Wheeler 1936, 178-9). The Prae Wood loom weight measured 116mm at its base, 54mm thick and 100mm in height. There were two perforations for attaching a cord or thread. The object found in the 1998 evaluation was twice that size, and may have been a thatch weight. It is similar to one found at Gorhambury (Neal *et al* 1990, 163, 1032) which measured 176mm at its base and 180mm high. Another example from the Foxholes site near Hertford (Partridge 1989) measures 185mm at the base, 160mm in height and 70mm in thickness. A cruder version of a loom or thatch weight was found at Lobs Hole (Hunn 2005) in a 2nd-century context. This consisted of a crude T-shaped lump of chalk, 160 × 120 × 100mm, which appeared to have once had been used as a weight of some description.

### ENVIRONMENTAL REPORT

James Rackham

One 30-litre sample from the primary fill [014] of the third recut [037] from ditch segment 042 was assessed. Its sample volume and weight were measured prior to

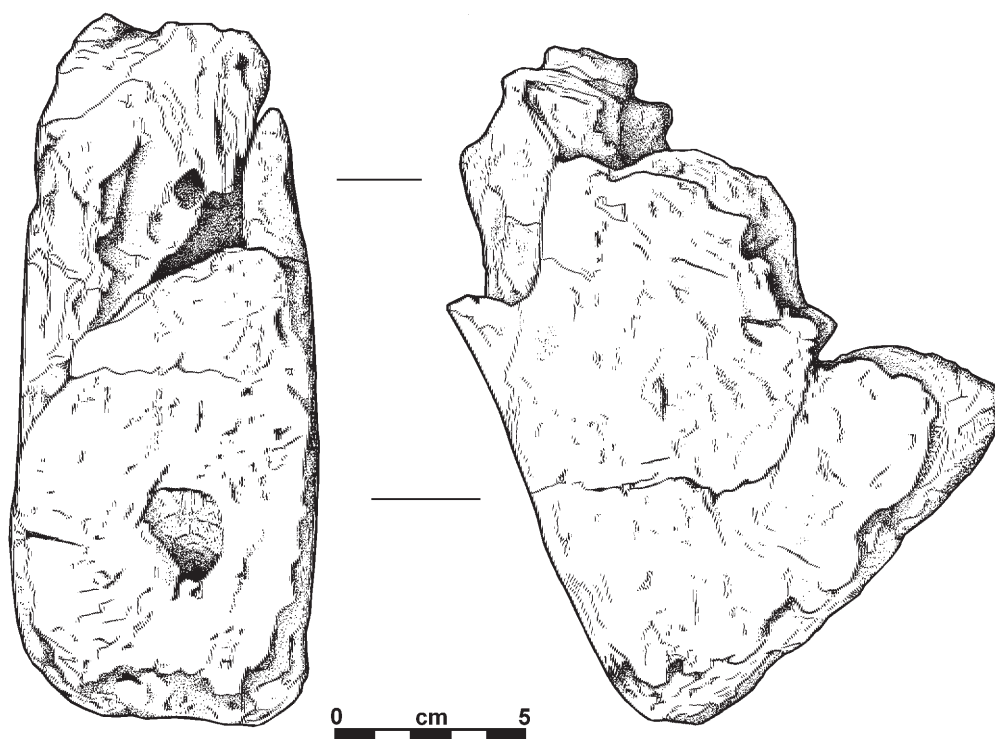

Fig 7 Clay weight (scale 1:2)

processing. The sample was washed in a 'Siraf' tank using a flotation sieve with a 0.5mm mesh and an internal wet-sieve of 1.0mm mesh for the residue. Both residue and flots were dried. The residue was then re-floated, to improve the recovery efficiency of the carbonised remains, the second flots being caught on a 0.125mm mesh. The residue and second flots were then re-dried. The dry volume of the flots was measured, and the weight of the residue recorded. No preserved waterlogged material survived in the sample.

The sample residue was sorted by eye and environmental and archaeological finds picked out, noted on the assessment sheet and bagged independently. A magnet was then run through the residue to pick up any magnetised material, particularly flake and spheroidal hammer scale, after which the residue was bagged. The flots were studied under a low-power binocular microscope. The presence of environmental finds (*i.e.* snails, charcoal, carbonised seeds, bones etc.) was noted and their abundance and species diversity recorded on the assessment sheet. The flots were then bagged. The flots and sorted finds constitute the material archive of the sample. The sorted residue was discarded.

## Results

The sample was a coarse gravelly silt loam, with quantities of gravel over 7.0mm diameter. 196g of pottery (46 sherds) was sorted from the residue and included a number of fabrics and forms, and a small quantity of fired clay (58g) which may be part of the fragmented loom weight (Fig. 7). A small quantity of bone was recovered, much of it burnt and calcined, with the unburnt material showing severe surface corrosion. Identifiable pieces included an ovicaprid rib (sheep or goat), tooth enamel fragments, and a probable cattle jaw fragment. A small amount (13g) of small twig and roundwood charcoal were extracted, a single carbonised grain of cereal and one or two charred seeds.

The environmental potential of this sample is extremely low. Bone survival is clearly poor, with only calcined bone surviving in good condition. Although there are quantities of small charcoal little is likely to be identifiable and does not warrant analysis. The carbonised plant seeds do not warrant further work. Despite a relatively high ceramic content the remainder of the material indicates little more than the debris from a small fire.

## DISCUSSION

Before the most recent investigations, the precise location of the enclosure at Stanborough School was not known, because the location plan of the site published by Arnold (1952-54, fig. 2) was not clear. However, an examination of the plan in relation to modern Ordnance Survey mapping of the area reveals that there is now sufficient information to locate the position of the enclosure ditches identified in the early 1950s.

The 1953 investigations revealed an enclosure defined by a single ditch, in some places two ditches, amounting to a length of 183m, out of a total projected circumference of 215m. Of this, some 48m, 22% of the total projected circumference, was exposed during the course of building work. This allowed the site to be categorised, using current terminology, as an '*irregular single-ditched long quadrilateral enclosure*' (Hunn 1996, 21). However, this classification might be an oversimplification, as in the published section

and text an inner ditch appears to have run parallel with the enclosure boundary (Arnold 1952-54, 128 and fig. 2). This feature was set about 1.2m from the outer ditch, and measured approximately 1.3m wide and 0.5m deep. The inner ditch was not located during the most recent evaluations, though it is quite possible that if it lay more than 2.0m from the outer ditch it would have been beyond the limits of the trenches. Arnold recorded no finds from the inner ditch, nor was its precise relationship to the outer ditch established. Judging by the published section (*ibid.*, fig. 2, section A-A) the inner ditch could not have been contemporary, and it is probable that it represents an earlier enclosure ditch.

There was little evidence of internal structures contemporary with the enclosure. This is not surprising, given the nature of the site and the circumstances of the investigation. To the north of the enclosure two burial groups have been recorded (Arnold 1952-54, 128). The first was found in the 1930s and is now lost. The second was found in the early 1950s, and is described as follows: the '*burial group consisted of a badly smashed coarse ware urn, a flat Samian dish which was probably the lid to the urn, and two other Samian dishes*' (*ibid.*). The Samian may have been as late as the early 2nd century; therefore the burials were later than the upper fills of the enclosure ditch.

The finds from Arnold's trenches A and B are described as follows: 'Most of the pottery was broken but in great quantity, and were there not a building up of the soil of about 3 ft above the Belgic level in this area, excavation would have been easy and probably produced a good collection of pottery. The filling of the Belgic ditch in this area was a crumbly black soil plentiful in charcoal and was likely put there when the site was deliberately cleared at the end of occupation' (Arnold 1952-54, 128). It was noted that some Gallo-Belgic wares were present, but only a relatively small quantity (*ibid.*, 134). The non coarse-ware pottery finds were a coin of Claudius, a fragment of La Tène III brooch found in the 1938 investigations, a fragment of a copper-alloy ring, a triangular loom weight similar to that found at Prae Wood (Wheeler & Wheeler 1936, 179), worked flints, fragments of Belgic brick, Roman tile and brick and ox and horse teeth. The pottery assemblage was described as follows: 'The bulk of the pottery, including whole or nearly whole pots, is from the top of the ditch filling and may well be the result of clearing up the site and filling in the ditch early in the Roman period. It all falls within the period AD 20-60, and the emphasis is in favour of the post-Conquest date for most of it' (*ibid.*, 131).

It is apparent that the pottery assemblage from Trenches 1 and 2 resulted from fairly rapid deposition. Individual vessels had been broken and then discarded in the ditch surrounding the settlement. There was a noticeable dissimilarity between the ditch segments recorded in 1997 and 1998. Those recorded in 1997 had been recut, and contained several fills. In contrast, the 1998 segment appeared to reveal no evidence for any recuts, and apparently contained only a single fill. It is hard to account for this in terms of the soil conditions because the ground was relatively damp. However, the 1997 evaluation was undertaken in late February, whereas the 1998 evaluation was carried out in mid/late December. The personnel were similar, and if anything more experienced in the second evaluation phase.

Another difference between the two excavations was the greater depth of soils overlying the archaeological deposits in 1998. In the 1997 evaluation the archaeology was encountered 0.75m below the present surface, compared with the 1998 evaluation, which revealed an overburden depth of 1.25m. To judge from the northwest facing section it appeared that Ditch [109] was cutting [106], some kind of hollow or natural depression. The dimensions of the 1998 ditch suggest that it may have declined in size, although this has been exaggerated by the slight truncation caused by the mechanical excavator.

The contents of the 1998 ditch were broadly similar to those derived from the 1997 evaluation. The pottery consisted predominantly of grog-tempered wares of 1st-century date but with some other wares indicating that deposition occurred in the early 2nd century. Of particular interest was a crude hand-made cup tempered with occasional fragments of flint and organic material, possibly grass. There was a single sherd of amphora and fragments of a clay loom weight. There was a complete absence of animal bones, but no significance should be attached to this since there is poor preservation of bone material in these soils. In the light of the initial environmental assessment, no samples were taken in 1998. The environmental analysis suggests that the assemblage represents only domestic rubbish cleared away from dwelling areas. Based on the comparatively large size of some of the pottery sherds and the high percentage of complete vessels, it seems that this part of the site was in close proximity to the inhabited area of the enclosure.

Although the range of material from the 1997/98 evaluations was not great, when combined with the finds from the 1950s it makes a useful contribution to our understanding of the material culture of the site. The single largest element is the ceramic assemblage, which has been discussed above. Consideration is given here to the more general implications of this evidence. It is not possible to compare the collection with the material recovered by Arnold as, apart from general typologies, no quantification was produced. However, it is possible to derive some idea of quantity from the latest evaluation work. This may be expressed as follows:

1997 evaluation: 29149g from 2.205 cu. m.,  
or 13219.5g/cu m.

1998 evaluation: 6129g from 0.374 cu. m.,  
or 16387.7g/cu m.

This demonstrates that although more pottery was recovered in 1997 there was, in fact, a greater concentration of pottery recovered in the 1998 evaluation. Although the concentrations of pottery were high, there are other examples where the deposits were greater. For example, four ditch deposits from Lobs Hole, Stevenage (Hunn 2005) ranged in size from between 14591g/cu m. to 27240g/cu m. These were mainly mid/late 1st-century to early 2nd-century deposits.

The total length of ditch excavated in 1997/98 comes to 4.57m, which represents a 2.12% sample of the full length of the enclosure ditch. Hypothetically, if the quantity of pottery recovered from the 1997/98 evaluations was representative of the enclosure ditch as a whole, then figures of 13678.9g/cu m, and a pottery assemblage weight of 1468981.9g, would be obtained. This amount looks suspiciously high,

and may be compared with the more extensively excavated site of Lobs Hole, where the estimated total comes to 932kg. (*ibid.*). It has been observed that the pottery dumps appear to have been concentrated on the southern side of the enclosure, so that the concept of a relatively uniform discard pattern throughout the length of the enclosure ditch appears unlikely. As expected, the assemblage shows a strong preference for jar-type vessels, with a relatively restricted use of non-jar types and imported forms.

Thompson's analysis of the assemblage shows that it accumulated in a short period of time. These periods of clearance are a characteristic of such enclosure sites, and although the results of this activity can be studied their actual cause is less understood. The fact that domestic detritus and pottery was deposited into an existing ditch might suggest that the ditch, as opposed to the boundary, no longer served any purpose. We know from other Hertfordshire enclosure sites (eg. Prae Wood, Lobs Hole, Gorhambury) that settlements continued to function long after this 'event' took place. However, the question of continuity in its strictest sense is a matter of debate. What could be the reason for the deliberate discarding of apparently serviceable items of pottery? Two principal interpretations, ritual/symbolic or social/functional, suggest themselves. In the former case the inhabitants presumably underwent a collective desire to discard all their existing containers and replace them with new ones as the result of 'fashion' or possible prestige. Alternatively, such periodic clearances were the result of expurgation/purification caused by the death of a dominant matriarch or by a change in 'ownership' or occupation of the settlement. The fact that the assemblage included items of varying date suggests it was amassed over a period of time. Its subsequent disposal was therefore an event precipitated by either an external stimulus such as change in fashion or, as this author would prefer, by some occurrence within the local community which required an appropriate response in the form of ritual clearance.

With regards to the final date of the abandonment of the enclosure our information is still inadequate. We know that some individual cremations from the site have a 2nd-century date, but that does not demonstrate whether occupation continued to or beyond that period. Based on the evidence of the pottery from the enclosure ditch, Thompson has suggested that there was a deliberate termination of occupation in the middle of the 1st century AD. Whether there was any relationship to the Boudiccan revolt is not certain, but such a possibility cannot be easily dismissed. The question of ceramic clearance and deposition from late Iron Age sites in Hertfordshire has yet to be assessed in detail.

In addition to the pottery, several finds were recovered which enhance our understanding of the economic and cultural aspects of the settlement's inhabitants. There were fragments of a loom or thatch weight, a portion of a hand rotary quern and six fragments of burnt stone, presumably potboilers. The quernstone came from Context 013 in the final recut of ditch Segment 042. The potboilers and a clay weight came from Context 108. The weight was badly smashed, but sufficient survived for its form to be reconstructed.

### Status and Society

It has been argued elsewhere (Hunn 2005) that there is a relationship between a native farmstead of the 1st

Table 4. Comparative IA/RB enclosure sites in the Chilterns and Hertfordshire

Name	Location	Width (m)	Depth (m)	Length (m)	Area (ha)	Enc. Ditch (cu. m)	HER ref	Pub. ref.
Great Humphreys	Aston	5.6	2.92	248	0.39	2027.648	6309	1
Datchworth	Datchworth	3.75	2	298	0.54	1117.5	1898	1
Gorhambury P5	St Albans	2.2	1.6	550	1.38	968	0504	2
Prae Wood I	St Albans	3.9	1.5	315	0.65	921.375	0003	3
Harpندن III	St Albans	3.5	2	260	0.36	910	6820	4
Ivinghoe	Ivinghoe	3.8	1.6	275	0.35	836	1198	5
Gorhambury P4	St Albans	2	2	390	0.9	780	0504	2
Astonbury	Aston	1.9	1.2	676	0.58	770.64	7971	1
Gorhambury P3	St Albans	2	2	360	0.72	720	0504	2
Foxholes	Hertford	2.6	1.05	455	0.83	621.075	2131	6
Nutfield	Welwyn	4.2	1.2	200	0.69	504	1589	7
Boxfield Farm	Stevenage	1.4	0.7	720	1.86	352.8	4506	8
Lobs Hole p v	Stevenage	2.52	1.5	174	0.25	328.86	9222	9
Lobs Hole av.	Stevenage	1.95	1.12	280	0.39	305.76	9222	9
Hollard's Farm	Codicote	1.7	1.05	235	0.39	209.7375	2388	10
Stanborough	Welwyn	1.35	0.74	215	0.28	107.3925	1735	11
Ashridge (A1)	Ashridge	1.8	1	?	?	?	-	5
Ashridge (A2)	Ashridge	2.6	1.4	?	?	?	-	5
Ashridge (P1)	Ashridge	2.7	1.4	?	?	?	-	5
Brickwall Hill	Welwyn	2.13	1.06	?	?	?	2291	1
Crookhams	Welwyn	1.8	0.75	?	?	?	1142	12
Grubs Barn	Welwyn	3	1.7	?	?	?	2818	13
New Danesbury	Welwyn	3.4	1.37	?	?	?	9267	1
Parkbury	St Albans	2	1	?	?	?	0929	14

Publication references: (1) Rook, A., pers comm; (2) Neal *et al* 1990, 13; (3) Wheeler and Wheeler 1936, 41; (4) Havercroft and Niblett pers comm.; (5) Wainwright pers comm.; (6) Partridge 1989, 31; (7) Rook 1968a 121; (8) Going and Hunn forthcoming; (9) Hunn forthcoming; (10) Burleigh, Went and Mathews; (11) Arnold 1952-54, 128-37; Hunn 1997; (12) Rook 1968b 51; (13) Rook 1970, 31; (14) Niblett 1990.

century and its status within the settlement hierarchy of its locality. The average excavated dimensions of the ditch that surrounded the Stanborough enclosure were 1.35m wide by 0.74m deep, producing a total volume of 107.39 cu. m. It is probable that the original average dimensions were of the order of 2.10 × 1.05m, thereby producing a volume of 237 cu. m. of excavated material. These dimensions are hardly dramatic, and are not far removed from the typical Victorian boundary ditch of 1.50m width × 0.76m depth (Vernon 1899, 22-23). To date, no entrances or causeways across the ditch have been identified. However, if the Lobs Hole enclosure is anything to go by, one should not expect anything more sophisticated than simple breaks in the circuit. One element noted by Arnold (1952-4, 128) was the existence of an internal 'palisade trench' some 1.22m from the interior lip of the outer ditch. As is often the case with these lesser features, there is no certainty with regards to the relationship between such features. The palisade is unlikely to be a later feature on the grounds of its proximity to the internal bank. It may have pre-dated the later enclosure ditch, or it may have been contemporary with it. If the latter is correct, then it may have been built to act as a revetment for the bank material. The palisade was only noted on the western or downhill side of the enclosure. The advantages of such an arrangement would have been made to increase the security of both the human and animal

occupants of the settlement. It is also possible that this was the more 'exposed' side from the point of view of anyone approaching from the valley below. Such an interest in the aspect of social status would be quite plausible.

It is possible to make a comparison with other enclosure sites in Hertfordshire (Table 4). It can be seen that in terms of area the Stanborough site is the smallest enclosure in the group. Similarly, its ranking according to the quantity of cubic metres dug to construct the enclosure is also the smallest of any excavated or partly excavated site. At present it is not possible to reconstruct the 1st-century social hierarchy of the Welwyn area with any certainty. However, based on the evidence we have it seems probable that Stanborough was a native settlement of class 5 (Hunn 2005, 143) with little or no pretensions towards Romanisation.

## THE ARCHIVE

On completion of the published report, the project archive will be deposited with Welwyn Hatfield Museum.

## Acknowledgements

The author would like to thank the late Rob Grinter, formerly of the Education Department of Hertfordshire County Council for commissioning the fieldwork and post-

excavation studies at Stanborough. Thanks are also due to Tony Hurley and Alex Hunt of the County Archaeology Office for their advice and support throughout the course of the project. The author is also indebted to Ms G. Tolley, headmistress of Stanborough School, for her co-operation during the fieldwork stages of the project. Finally the writer is grateful to Bob Zeevat for the final editing of the publication text.

## Bibliography

- Andrews, R T 1905 'Roman occupation at Welwyn', *East Hertfordshire Archaeol Soc. Trans* **2.1**, 28.
- Arnold, B J 1952-54 'Belgic settlement at Welwyn', *East Hertfordshire Archaeol Soc. Trans* **13.2**, 128.
- Avery, B W 1964 *The Soils and Land Use of the District around Aylesbury and Hemel Hempstead*. H.M.S.O (London).
- Burleigh, G, Went, D & Mathews, K 1990 *An archaeological evaluation at Hollard's Farm, Letchworth*. North Herts District Council Museums Field Archaeol Section rep.
- Dannell, G B, & Wild, J P 1987 *Longthorpe II: the military work-depot: an episode in landscape history*. Britannia Monog. Ser. **8** (London).
- Davies, B, Richardson, B & Tomber, R 1994 *A dated corpus of early Roman pottery from the City of London*. Council for British Archaeol / Museum of London (York).
- Davies, E S & Mawhinney, M 1985 'The deserted medieval village of Box', *Hertfordshire's Past* **18**, 12-17.
- Elsdon, S M 1975 *Stamped and rouletted decorated pottery of the La Tène period in eastern England: a study in geometric design*. British Archaeol Repts **10** (Oxford).
- Frere, S S 1984 *Verulamium excavations volume III*. Oxford University Committee for Archaeol (Oxford).
- Going, C J & Hunn, J R 1999 *Excavations at Boxfield Farm, Chells, Stevenage, Hertfordshire*. Hertfordshire Archaeol Trust Rep **2** (Hertford).
- Hodge, C A H, Burton, R G O, Corbett, W M, Evans, R & Seale, R S 1984 *Soils and their use in Eastern England*. Soil Survey of England & Wales Bulletin **13** (Harpending).
- Hughes, W R 1938 'Roman Occupation in Welwyn', *East Hertfordshire Archaeol Soc. Trans* **10.2**, 141.
- Hunn, J R 1980 'The earthworks of Prae Wood: an interim account', *Britannia* **11**, 21-30.
- Hunn, J R 1996 *Settlement Patterns in Hertfordshire: a review of the typology and function of enclosures in the Iron Age and Roman Landscape*. British Archaeol Repts **249** (Oxford).
- Hunn, J R 2005 *Lobs Hole, Stevenage: A Romano-British Farmstead*. Heritage Network Monog. Ser. **1** (Letchworth).
- Johnson, A A 1998 *Stanborough School, Welwyn Garden City: Magnetometer (Gradiometer) Survey*. Oxford Archaeotechnics, survey ref: 1560898/WGH/HCC. Unpub. rep.
- MAFF 1979 *Agricultural Land Classification of England and Wales*. Sheet 149 & accompanying report. Ministry of Agriculture, Fisheries and Food.
- Marney, P T 1989 *Roman and Belgic pottery from excavations in Milton Keynes, 1972-82*. Buckinghamshire Archaeol Soc. Monog. **2** (Aylesbury).
- Mayes, A 1908 'A Romano-British cemetery at Welwyn', *East Hertfordshire Archaeol Soc. Trans* **4.1**, 117.
- Niblett, R 1990 *Excavations at Verulamium Museum: interim report*. unpub.
- Niblett, R 1999 *The excavation of a ceremonial site at Folly Lane, Verulamium*. Britannia Monog. Ser. **14** (London).
- Partridge, C 1980-82 'Braughing, Wickham Kennels 1982', *Hertfordshire Archaeol* **8**, 40-59.
- Partridge, C 1981 *Skeleton Green: a Late Iron Age and Romano-British site*. Britannia Monog. Ser. **2** (London).
- Partridge, C 1989 *Foxholes Farm. A multi-period gravel site*. Hertfordshire Archaeol Trust Monog. Alan Sutton (Gloucester).
- Rook, A G 1968a 'Investigation of a Belgic occupation site at Crookhams, Welwyn Garden City'. *Hertfordshire Archaeol* **1**, 51-65.
- Rook, A G 1968b 'A Belgic Ditched Enclosure at Nutfield, Welwyn Garden City', *Hertfordshire Archaeol* **1**, 121-22.
- Rook, A G 1970 'A Belgic and Roman Site at Grubs Barn, Welwyn Garden City', *Hertfordshire Archaeol* **2**, 23-30.
- Rook, A G 1973 'Excavations at the Grange Romano-British cemetery, Welwyn, 1967', *Hertfordshire Archaeol* **3**, 1-30.
- Saunders, C & Havercroft, A B 1980-82 'Excavations on the line of the Wheathampstead by-pass, 1974 and 1977', *Hertfordshire Archaeology* **8**, 11-31.
- Stead, I M 1967 'A La Tène III burial at Welwyn Garden City', *Archaeologia* **101**, 1-62.
- Stead, I M & Rigby, V 1986 *Baldock: the excavation of a Roman and pre-Roman settlement, 1968-72*. Britannia Monog. Ser. **7** (London).
- Stead, I M & Rigby, V 1989 *Verulamium: the King Harry Lane site*. English Heritage Archaeol Rep. **12** (London):
- Thompson, I 1979 'Wheathampstead revisited', *Bull. University London Inst. Archaeol* **16**, 159-85
- Thompson, I M 1982 *Grog-tempered 'Belgic' pottery of south-eastern England*. British Archaeol Repts **108** (Oxford).
- Tyers, P 1996 *Roman Pottery in Britain*. Batsford (London).